

Agenda
Courtland City Council
Thursday, April 4, 2024 7:00pm
Courtland City Hall
329 Main Street

6:30 Local Board of Appeal Public Hearing

1. Call to Order
2. Roll Call-Attendance
3. Additions/Approval of the Agenda
4. Approval of Minutes- Regular CC
5. Presentation and Payment of Bills
6. Visitors
Eric Hauser Pat Stadick John Stadick

7. Reports
 - A. Public Utilities
 - B. Mayor and Council
 - C. Streets Committee
 - D. Planning Commission
 - E. City Clerk

8. Unfinished Business
Main Street (Lions) Park Improvements

9. New Business

Resolution 24-110 Resolution Accepting & Award Bid 2024 Collin Drive Project
Resolution 24-111 Resolution Approving Conditional Use Permit G & S Manufacturing
Courtland Rec Assn annual Liquor License
Collin Drive Project financing

10. Adjournment

Mission of the City of Courtland

We envision Courtland as a city with managed growth which offers a high quality of life for individuals, families and businesses at an affordable cost.

City Council Minutes

Regular Meeting

March 7, 2024

Members Present: Council Member Pam Rodewald
Council Member Justin Kraus
Council Member Ralph Bents
Council Member Paul Bode

Members Absent: Mayor Al Poehler

Others Present: Julie Holm Dave Ubel Mark Fiemeyer Eric Hauser Karen Fluegge Bob Schabert

The regular city council meeting was called to order by Acting Mayor Ralph Bents at 7:00 pm on March 7, 2024 in the Council chambers in City Hall.

Rodewald made a motion to approve the amended agenda. Kraus seconded the motion. The motion carried with all in favor.

Kraus made a motion to approve February 1, 2024 regular Council minutes. Bode seconded the motion. Motion carried with all in favor.

Bode made a motion to approve February 1, 2024 special Council minutes. Rodewald seconded the motion. Motion carried with all in favor.

Rodewald made a motion to approve monthly bills. Kraus seconded the motion. Motion carried with all in favor.

	Vendor	DATE	\$AMT	Description
EFT	MICROSOFT	08-Feb-24	\$8.86	office 365 subscription
EFT	IRS	09-Feb-24	\$920.67	federal payroll taxes
EFT	MN DEPT OF REVENUE	09-Feb-24	\$168.00	mn payroll taxes
EFT	PERA	09-Feb-24	\$571.95	PERA contributions
EFT	IRS	22-Feb-24	\$892.67	federal payroll taxes
EFT	MN DEPT OF REVENUE	22-Feb-24	\$163.00	mn payroll taxes
EFT	PERA	22-Feb-24	\$557.37	PERA contributions
22617	Holm, Julie	07-Feb-24	\$1,134.48	Payroll 1/21-2/3/24
22618	Ubel, David	07-Feb-24	\$1,430.66	Payroll 1/21-2/3/24
22619	Voges, Jessie	07-Feb-24	\$652.79	Payroll 1/21-2/3/24
22620	LUEPKE OIL & TRUCKING LLC	05-Feb-24	\$221.94	fuel
22621	Nuvera	05-Feb-24	\$551.97	office,fax,fire hall,lifts,wells,wtr twr,wtr plnt intnet
22622	UNITED NATURAL GAS	15-Feb-24	\$1,792.54	main shed, firehall,wtr plant,cityoffice natural gas
22623	RUNNINGS SUPPLY, INC.	15-Feb-24	\$79.02	snow pusher, keys, hose washer, oil
22624	GOPHER STATE ONE-CALL	15-Feb-24	\$52.70	2 tickets
22625	COURTLAND MART	15-Feb-24	\$521.27	gas
22626	CITY OF NEW ULM	15-Feb-24	\$7,119.97	flow fees
22627	CITY OF COURTLAND	15-Feb-24	\$307.29	fire hall, comm center, main shed, city office utilities
22628	Voges, Jessie	21-Feb-24	\$677.17	Payroll 2/4-2/17/24
22629	Ubel, David	21-Feb-24	\$1,430.66	Payroll 2/4-2/17/24
22630	Holm, Julie	21-Feb-24	\$971.86	Payroll 2/4-2/17/24
22631	MN RURAL WATER ASSOCIATION	26-Feb-24	\$275.00	conference registration - Dave Ubel
22632	MN State Fire Chiefs Assoc	28-Feb-24	\$460.00	membership renewal
22633	NICOLLET COUNTY	28-Feb-24	\$46.00	record lien satisfaction - schmidt
EFT	COMCAST, INC	01-Mar-24	\$201.18	city office, comm center, fire hall internet
EFT	IRS	07-Mar-24	\$907.73	federal payroll taxes
EFT	MN DEPT OF REVENUE	07-Mar-24	\$166.00	mn payroll taxes
EFT	PERA	07-Mar-24	\$565.32	PERA contributions

EFT	IRS	21-Mar-24	\$902.78	federal payroll taxes
EFT	MN DEPT OF REVENUE	21-Mar-24	\$165.00	mn payroll taxes
EFT	PERA	21-Mar-24	\$562.30	PERA contributions
22634	Voges, Jessie	07-Mar-24	\$662.17	Payroll 2/18-3/2/24
22635	Ubel, David	07-Mar-24	\$1,430.66	Payroll 2/18-3/2/24
22636	Holm, Julie	07-Mar-24	\$942.81	Payroll 2/18-3/2/24
22637	BADGER METER	07-Mar-24	\$57.54	beacon web program support meter reading 386 units
22638	BLETHEN BERENS	07-Mar-24	\$270.00	phone call, email and letter Kuester Pit 2 development
22639	BOLTON & MENK, INC	07-Mar-24	\$8,474.00	Kuester Pit 2 sewer report, onsite mtg, collin dr project svcs
22640	CLEARWAY COMMUNITY SOLAR LLC	07-Mar-24	\$880.92	solar subscription
22641	CLIFTONLARSONALLEN	07-Mar-24	\$6,300.00	audit services YE2023
22642	COURTLAND MART	07-Mar-24	\$481.82	gas
22643	COURTLAND RURAL FIRE ASSOC	07-Mar-24	\$7,620.00	2024 budget contribution and 2023 budget shortfall
22644	ECOWATER SYSTEMS OF NEW ULM	07-Mar-24	\$16.80	softner salt
22645	GOPHER STATE ONE-CALL	07-Mar-24	\$6.75	6 tickets
22646	HAWKINS,INC	07-Mar-24	\$168.75	aqua hawk - water plant supplies
22647	RIVER BEND BUSINESS PRODUCTS	07-Mar-24	\$335.04	office supplies, whiteboard calendar for water plant
22648	VOID	07-Mar-24	\$0.00	VOID
22649	LUEPKE OIL & TRUCKING LLC	07-Mar-24	\$250.65	gas, fuel
22650	MINNESOTA DEPARTMENT OF HEALTH	07-Mar-24	\$546.00	1st qtr 2024 service connection fee
22651	MN LIFE INS COMPANY	07-Mar-24	\$10.00	dave life ins feb-mar
22652	Nuvera	07-Mar-24	\$548.70	office,fax,fire hall,lifts,wells,wtr twr,wtr plnt intnet
22653	PROKORE INSPECTIONS, LLC	07-Mar-24	\$106.57	permit fee remittance
22654	RUNNINGS SUPPLY, INC.	07-Mar-24	\$41.87	coupler, torch
22655	COLUMN SOFTWARE PBC	07-Mar-24	\$45.42	notice ph g&s offices 1001 main st
22656	UNITED NATURAL GAS	07-Mar-24	\$1,031.36	main shed, firehall,wtr plant,cityoffice natural gas
			\$53,075.90	

Eric Hauser from Bolton and Menk presents to council the plans and specifications that have been prepared for review with the expectation that council will approve and authorize to advertise for bids. In addition to Collin Drive Improvement Project being bid, Bolton and Menk has prepared the plans and specifications necessary for sidewalk project along County Road 24 for Main Street Park that city has been waiting for approval by Nicollet County. The bids will be separate from each other and council could opt to not proceed with sidewalk of cost is too much. Hauser has received information from Seth Greenwood that a turn lane will be required northbound. Council discussion on what has prompted this and asks for clarification from Seth on specific county policy requirements. Additional discussion on proposed costs for water line stubs to properties and if those that absolutely do not wish to have this put in place will be required to sign documents to that effect and the documents would have time frame they would not be allowed to make connections for possibly 10years. Hauser will draft letters of opting in or out of connection for next month council to consider. Council is in agreement that bidding should move forward to determine costs to be able to move forward.

Rodewald made a motion to approve Resolution 24-109 APPROVING PLANS AND SPECIFICATIONS AND ORDERING ADVERTISEMENT FOR BIDS COLLIN DRIVE IMPROVEMENTS. Kraus seconded the motion. Motion carried with all in favor.

**CITY OF COURTLAND
RESOLUTION 24-109**

RESOLUTION APPROVING PLANS AND SPECIFICATIONS AND ORDERING ADVERTISEMENT FOR BIDS FOR THE 2024 COLLIN DRIVE IMPROVEMENT PROJECT.

WHEREAS, Bolton and Menk, Inc., the consulting engineers for the City, has prepared final plans and specifications for 2024 Collin Drive Improvement Project and such plans and specifications have been presented to the Council for approval.

NOW THEREFORE BE IT RESOLVED BY THE CITY COUNCIL OF THE CITY OF COURTLAND, NICOLLET COUNTY, MINNESOTA.

1. Such plans and specifications are hereby approved and ordered placed on file in the office of the City Clerk.
2. The City Clerk shall prepare and cause to be inserted in the New Ulm Journal, the official newspaper, and online on QuestCDN which qualifies as a regional trade publication, an advertisement for bids upon the making of such improvements under such approved plans and specifications.

The advertisement shall be published in each of said publications at least once not less than three (3) weeks before the date set for opening bids, shall specify the work to be done, shall state that bids will be received until April 2, 2024 at 2:00 p.m. at Courtland City Hall, 329 Main Street, Courtland, Minnesota, at such time they will be publicly opened. No bids will be considered unless submitted as instructed and filed with the City Clerk and accompanied by a cash deposit, cashier's check, bid bond, or certified check payable to the City of Courtland for five percent (5%) of the amount of such bid.

The adoption of the foregoing resolution was duly moved by Councilmember Rodewald and seconded by Councilmember Kraus and after full discussion thereof and upon a vote being taken thereon, the following Councilmembers voted in favor thereof: Bents; Rodewald; Kraus; Bode

and the following voted against the same:

Whereupon said resolution was declared duly passed and adopted. Dated this 7th day of March, 2024.

Richard Krohn has made an application to Nicollet County to combine his lots 240 Ashlynn Court and 290 Collin Drive. Discussion on what the property will be assessed for the improvement project and combining the lots will lessen the amount of assessment. **Rodewald made motion to approve combining 240 Ashlynn Court PID: 14.591.0060 and 290 Collin Drive PID: 14.682.0010. Kraus seconded the motion. Motion carried with all in favor.**

Public Utilities: Dave reported last month main lift station is in need of replacement and the lift stations at Stony Point and Lagoon Drive are in need of repairs. Estimated cost of replacement for main lift station is \$80,000. Dave has made request from Quality Flow for quotes on each lift station. Quality Flow has done the service checks and repairs in the past and he would like to have them continue. Discussion on need for additional bids.

Dave also reports about the lead inventory of service lines will need to be completed in the next few months. This is a requirement by State of MN Health Department. Form letters are available to send out to residents to facilitate gathering the information.

No Mayor Report

Council Report: Bode asks if new chairs for community center have been ordered, Dave reports they have. Disposition of chairs being replaced is discussed.

Planning Commission: Holm reports public hearing for G & S Conditional Use Permit for offices at 1001 Main Street will take place at the March meeting. Continued discussion on doing survey for land use planning.

City Clerk: Julie reports PNP election went well with 100 citizens turning out the day of to vote. Julie will attend MCFOA Clerk's Conference March 19-22 and the city office will be closed.

Unfinished Business: Main Street (Lions) Park; Rodewald has been working to procure bids on equipment and will present at next month meeting.

Clerk presents municipality insurance tort limit liability waiver. Each year on municipality insurance renewal, council must vote on tort limit liability waiver.

Rodewald made a motion to waive tort limit liability. Bode seconded the motion. Motion carried with all in favor.

Dave Ubel as Fire Chief has an updated Mutual Aid Agreement for signature but needs clarification on who will sign. Dave also has copy of Joint Powers Agreement that was voted on at Annual Fire Meeting in February at which no one from city was able to attend. Rodewald asks for clarification of equation calculations.

Bode made a motion to adjourn. Kraus seconded the motion. Motion carried with all in favor.

Meeting adjourned 8:39pm

A signed written copy of the minutes is on file in the office of the city clerk.

Respectfully submitted,

Signed: _____
Ralph Bents, Acting Mayor

Attest: _____
Julie Holm, City Clerk

Check#	Vendor	Date	\$AMT	Description
EFT	IRS	21-Mar-24	\$902.78	federal payroll taxes
EFT	MN DEPT OF REVENUE	21-Mar-24	\$165.00	mn payroll taxes
EFT	PERA	21-Mar-24	\$562.30	PERA contributions
EFT	MICROSOFT	08-Mar-24	\$8.86	office 365 subscription
22657	POSTMASTER	07-Mar-24	\$272.00	postage
22658	COURI & RUPPE, P.L.L.P	13-Mar-24	\$248.44	legal services for fire dept joint powers agreement
22659	LOFFLER	13-Mar-24	\$86.74	mfp maintenance
22660	CITY OF COURTLAND	15-Mar-24	\$296.43	fire hall, comm center, main shed, city office utilities
22661	CITY OF NEW ULM	15-Mar-24	\$6,377.99	flow fees
22662	Holm, Julie	20-Mar-24	\$971.86	Payroll 3/3-3/16/24
22663	Ubel, David	20-Mar-24	\$1,667.18	Payroll 3/3-3/16/24
22664	Voges, Jessie	20-Mar-24	\$623.10	Payroll 3/3-3/16/24
22665	Compart, Ralph	18-Mar-24	\$135.00	PNP Election Judge Pay
22666	Fiemeyer, Mark	18-Mar-24	\$142.50	PNP Election Judge Pay
22667	Holm, Julie	18-Mar-24	\$269.86	PNP Election Judge Pay
22668	Juberien, Dawn	18-Mar-24	\$135.00	PNP Election Judge Pay
22669	Kahnke, Jean	18-Mar-24	\$135.00	PNP Election Judge Pay
22670	Woller, Carrie	18-Mar-24	\$142.50	PNP Election Judge Pay
22671	XCEL ENERGY	18-Mar-24	\$1,359.05	office,firehall,wrtwr,park,lifts,wtrplt,mainshed,st lights
EFT	IRS	04-Apr-24	\$1,143.40	federal payroll taxes
EFT	MN DEPT OF REVENUE	04-Apr-24	\$164.00	mn payroll taxes
EFT	PERA	04-Apr-24	\$602.69	PERA contributions
EFT	MICROSOFT	08-Apr-24	\$8.86	office 365 subscription
EFT	COMCAST, INC	04-Apr-24	\$191.18	city office, comm center, fire hall internet
EFT	IRS	18-Apr-24	\$902.69	federal payroll taxes
EFT	MN DEPT OF REVENUE	18-Apr-24	\$165.00	mn payroll taxes
EFT	PERA	18-Apr-24	\$563.05	PERA contributions
22672	BADGER METER	04-Apr-24	\$57.54	beacon web program support meter reading 386 units
22673	BOLTON & MENK, INC	04-Apr-24	\$30,512.50	Annual WCA Reporting, assist lift station pump sizing, Collin Drive Imp Project
22674	CLEARWAY COMMUNITY SOLAR	04-Apr-24	\$827.15	solar subscription
22675	CLIFTONLARSONALLEN	04-Apr-24	\$6,300.00	audit services YE2023 - 2nd installment
22676	COURTLAND FIRE DEPT REL-GEN	04-Apr-24	\$1,000.00	FIREFIGHTERS SBR REIMB
22677	DAKOTA SUPPLY GROUP	04-Apr-24	\$143.56	green/blue utility marking paint
22678	GOPHER STATE ONE-CALL	04-Apr-24	\$58.05	43 tickets
22679	HACH COMPANY	04-Apr-24	\$233.27	water plant supplies
22680	HAWKINS,INC	04-Apr-24	\$2,925.82	water plant chemicals
22681	LMC	04-Apr-24	\$742.50	reginal safety group training meetings
22682	LMCIT	04-Apr-24	\$21,688.00	municipality insurance
22683	LOFFLER	04-Apr-24	\$70.92	mfp maintenance, color copies
22684	LUEPKE OIL & TRUCKING LLC	04-Apr-24	\$85.88	FUEL
22685	MN LIFE INS COMPANY	04-Apr-24	\$5.00	dave life ins
22686	PROKORE INSPECTIONS, LLC	04-Apr-24	\$288.16	remit permit fees
22687	QUALITY FLOW SYSTEMS INC	04-Apr-24	\$290.48	lift station maintenance
22688	COLUMN SOFTWARE PBC	04-Apr-24	\$636.52	collin drive improvement bid advertising
22689	POSTMASTER	04-Apr-24	\$72.00	fire department po box fee
22690	POSTMASTER	04-Apr-24	\$408.00	general and utility postage
22691	Holm, Julie	04-Apr-24	\$1,502.22	Payroll 3/17-3/30/24
22692	Ubel, David	04-Apr-24	\$1,430.66	Payroll 3/17-3/30/24
22694	Voges, Jessie	04-Apr-24	\$627.08	Payroll 3/17-3/30/24
22695	Nuvera	04-Apr-24	\$545.25	office,fax,fire hall,lifts,wells,wtr twr,wtr plnt intrnet
			\$88,693.02	

ESOLUTION 24-111

Approval of Conditional Use Permit of Operating Business Offices for G & S Manufacturing, LLC

WHEREAS, Minnesota Statute 462.3595 authorizes and Section 303.13 Subd 6 of the Courtland City Code allows the approval of a conditional use permit (CUP) under certain circumstances;

WHEREAS, on February 27, 2024, Pat Stadick, owner G & S Manufacturing, LLC applied for a Conditional Use Permit to operate offices;

WHEREAS, the zoning designation of the site is I-1, Industrial;

WHEREAS, on March 21, 2024, the Courtland Planning Commission held a public hearing for the proposed CUP;

WHEREAS, the proposed CUP is for operating business offices of G & S Manufacturing, LLC ;

WHEREAS, neighboring property owners provided concerns about safety, noise, and animal control;

WHEREAS, the Planning Commission recommended the Council approve a conditional use permit for business operations;

WHEREAS, on April 4, 2024, the City Council considered the application and discussed it with Pat Stadick;

AND WHEREAS, the City of Courtland desires to protect the public health, safety, and welfare;

NOW, THEREFORE, BE IT RESOLVED THAT, the City of Courtland grants a conditional use permit for operating offices for G & S Manufacturing, LLC at the following property with the following conditions:

1001 Main Street in the City of Courtland, Nicollet County, Minnesota PIN: 14.006.0705

1. This CUP becomes void if not recorded at their expense by G & S Manufacturing, LLC at the Nicollet County Recorder's Office within 60 days of its approval. By recording this permit, G & S Manufacturing, LLC, indicate their agreement to abide by the conditions herein.
2. The CUP is valid for duration of operation upon approval and recording at the Nicollet County Recorder's Office.

Passed by the City Council for the City of Courtland on the 4th day of April, 2024.

Signed: _____

Al Poehler, Mayor

Attest: _____

Julie Holm, City Clerk

**CITY OF COURTLAND
RESOLUTION 24-110**

**A RESOLUTION RECEIVING BIDS AND AWARDING THE CONTRACT FOR THE
2024 COLLIN DRIVE IMPROVEMENT PROJECT**

WHEREAS, the 2024 Collin Drive Improvement Project consists of street and utility improvements on Collin Drive from 4th Street (CSAH 24) to 1300 feet east of 4th Street; AND

WHEREAS, The City received bids on April 2, 2024 for the 2024 Collin Drive Improvement Project; AND

WHEREAS, the bids were tabulated and analyzed as follows:

Bidder	Base Bid	Add Alternate No. 1	Add Alternate No. 2	Total Base Bid Plus Add Alternates
W.W. Blacktopping, Inc.	\$451,317.45	\$38,957.85	\$43,924.85	\$534,200.15
M.R. Paving & Excavating, Inc.	\$466,407.08	\$34,492.80	\$43,282.04	\$544,181.92
Precision Underground LLC	\$496,463.32	\$43,644.79	\$53,255.77	\$593,363.87
Mensing Construction	\$533,405.00	\$38,632.00	\$49,891.00	\$621,928.00
GM Contracting, Inc.	\$549,323.38	\$43,518.70	\$61,837.16	\$654,679.24
Engineer's Estimate	\$547,174.00	\$51,404.00	\$47,545.25	\$646,123.25

NOW THEREFORE BE IT RESOLVED BY THE CITY COUNCIL OF THE CITY OF COURTLAND, MINNESOTA THAT;

1. All bids on the 2024 Collin Drive Improvement Project are hereby received and tabulated.
2. Awarding the Base Bid and both Add Alternates to WW Blacktopping in the amount of \$534,200.15 for the 2024 Collin Drive Improvement Project in accordance with the plans and specifications and advertisement for bids is the lowest responsible bid and hereby is accepted.
3. The Mayor and City Clerk are hereby authorized and directed to enter into a contract with said bidder for the construction of said improvements for and on behalf of the City.
4. The City Clerk is hereby authorized and directed to return forthwith to all bidders the deposits made with their bids, except that the deposit of the successful bidder and the next lowest bidder shall be retained until a contract has been executed.

The adoption of the foregoing resolution was duly moved by Councilmember _____ and seconded by Councilmember _____, and after full discussion thereof and upon a vote being taken thereon, the following Councilmembers voted in favor thereof:

and the following voted against the same:

Whereupon said resolution was declared duly passed and adopted. Dated this 4th day of April 2024.

ATTEST:

Al Poehler, Mayor

Julie Holm, City Clerk



Real People. Real Solutions.



1960 Premier Drive
Mankato, MN 56001
Phone: (507) 625-4171
Fax: (507) 625-4177
Bolton-Menk.com

April 2, 2024

Julie Holm
City Clerk
City of Courtland
329 Main Street
Courtland, MN 56021

RE: 2024 Street & Storm Sewer Improvements
City of Courtland, MN
BMI Project No.: OM1.132644

Dear Julie,

Bids were received and opened electronically through QuestCDN at City Hall on Tuesday, April 2 at 2:00 pm for the project referenced above. Five (5) bids were received, and the results of the bids are tabulated below:

Table with 5 columns: Bidder, Base Bid, Add Alternate Bid No. 1, Add Alternate Bid No. 2, Total Base Bid Plus Add Alternates 1 & 2. Rows include W.W. Blacktopping, Inc., M.R. Paving & Excavating, Inc., Precision Underground LLC, Mensing Construction, GM Contracting, Inc., and Engineer's Estimate.

The low bidder for the project is W.W. Blacktopping, Inc. from Mankato, Minnesota. The low bid is approximately 17% below the Engineer's Estimate and the next lowest bid is approximately 2% over the low bid. A detailed bid abstract of all the bids and the engineer's estimate is attached for your review.

Based on past performance on similar projects in previous years, it is our opinion that W.W. Blacktopping, Inc. is qualified to perform the work required under this contract. If deemed financially feasible, we hereby recommend that W.W. Blacktopping, Inc. be awarded the Base Bid and Add Alternates No. 1 and 2 for the contract based on the bid contract amount of \$534,200.15. Please keep their attached submitted documents for your records.

Sincerely,
Bolton & Menk, Inc.

Handwritten signature of D. Joseph Duncan II

D. Joseph Duncan II, P.E.
City Engineer

Enclosure

Mission of the City of Courtland

We envision Courtland as a city with managed growth which offers a high quality of life for individuals, families and businesses at an affordable cost.

City Council Minutes

Regular Meeting

March 7, 2024

Members Present: Council Member Pam Rodewald
Council Member Justin Kraus
Council Member Ralph Bents
Council Member Paul Bode

Members Absent: Mayor Al Poehler

Others Present: Julie Holm Dave Ubel Mark Fiemeyer Eric Hauser Karen Fluegge Bob Schabert

The regular city council meeting was called to order by Acting Mayor Ralph Bents at 7:00 pm on March 7, 2024 in the Council chambers in City Hall.

Rodewald made a motion to approve the amended agenda. Kraus seconded the motion. The motion carried with all in favor.

Kraus made a motion to approve February 1, 2024 regular Council minutes. Bode seconded the motion. Motion carried with all in favor.

Bode made a motion to approve February 1, 2024 special Council minutes. Rodewald seconded the motion. Motion carried with all in favor.

Rodewald made a motion to approve monthly bills. Kraus seconded the motion. Motion carried with all in favor.

	Vendor	DATE	\$AMT	Description
EFT	MICROSOFT	08-Feb-24	\$8.86	office 365 subscription
EFT	IRS	09-Feb-24	\$920.67	federal payroll taxes
EFT	MN DEPT OF REVENUE	09-Feb-24	\$168.00	mn payroll taxes
EFT	PERA	09-Feb-24	\$571.95	PERA contributions
EFT	IRS	22-Feb-24	\$892.67	federal payroll taxes
EFT	MN DEPT OF REVENUE	22-Feb-24	\$163.00	mn payroll taxes
EFT	PERA	22-Feb-24	\$557.37	PERA contributions
22617	Holm, Julie	07-Feb-24	\$1,134.48	Payroll 1/21-2/3/24
22618	Ubel, David	07-Feb-24	\$1,430.66	Payroll 1/21-2/3/24
22619	Voges, Jessie	07-Feb-24	\$652.79	Payroll 1/21-2/3/24
22620	LUEPKE OIL & TRUCKING LLC	05-Feb-24	\$221.94	fuel
22621	Nuvera	05-Feb-24	\$551.97	office,fax,fire hall,lifts,wells,wtr twr,wtr plnt intnet
22622	UNITED NATURAL GAS	15-Feb-24	\$1,792.54	main shed, firehall,wtr plant,cityoffice natural gas
22623	RUNNINGS SUPPLY, INC.	15-Feb-24	\$79.02	snow pusher, keys, hose washer, oil
22624	GOPHER STATE ONE-CALL	15-Feb-24	\$52.70	2 tickets
22625	COURTLAND MART	15-Feb-24	\$521.27	gas
22626	CITY OF NEW ULM	15-Feb-24	\$7,119.97	flow fees
22627	CITY OF COURTLAND	15-Feb-24	\$307.29	fire hall, comm center, main shed, city office utilities
22628	Voges, Jessie	21-Feb-24	\$677.17	Payroll 2/4-2/17/24
22629	Ubel, David	21-Feb-24	\$1,430.66	Payroll 2/4-2/17/24
22630	Holm, Julie	21-Feb-24	\$971.86	Payroll 2/4-2/17/24
22631	MN RURAL WATER ASSOCIATION	26-Feb-24	\$275.00	conference registration - Dave Ubel
22632	MN State Fire Chiefs Assoc	28-Feb-24	\$460.00	membership renewal
22633	NICOLLET COUNTY	28-Feb-24	\$46.00	record lien satisfaction - schmidt
EFT	COMCAST, INC	01-Mar-24	\$201.18	city office, comm center, fire hall internet
EFT	IRS	07-Mar-24	\$907.73	federal payroll taxes
EFT	MN DEPT OF REVENUE	07-Mar-24	\$166.00	mn payroll taxes
EFT	PERA	07-Mar-24	\$565.32	PERA contributions

EFT	IRS	21-Mar-24	\$902.78	federal payroll taxes
EFT	MN DEPT OF REVENUE	21-Mar-24	\$165.00	mn payroll taxes
EFT	PERA	21-Mar-24	\$562.30	PERA contributions
22634	Voges, Jessie	07-Mar-24	\$662.17	Payroll 2/18-3/2/24
22635	Ubel, David	07-Mar-24	\$1,430.66	Payroll 2/18-3/2/24
22636	Holm, Julie	07-Mar-24	\$942.81	Payroll 2/18-3/2/24
22637	BADGER METER	07-Mar-24	\$57.54	beacon web program support meter reading 386 units
22638	BLETHEN BERENS	07-Mar-24	\$270.00	phone call, email and letter Kuester Pit 2 development
22639	BOLTON & MENK, INC	07-Mar-24	\$8,474.00	Kuester Pit 2 sewer report, onsite mtg, collin dr project svcs
22640	CLEARWAY COMMUNITY SOLAR LLC	07-Mar-24	\$880.92	solar subscription
22641	CLIFTONLARSONALLEN	07-Mar-24	\$6,300.00	audit services YE2023
22642	COURTLAND MART	07-Mar-24	\$481.82	gas
22643	COURTLAND RURAL FIRE ASSOC	07-Mar-24	\$7,620.00	2024 budget contribution and 2023 budget shortfall
22644	ECOWATER SYSTEMS OF NEW ULM	07-Mar-24	\$16.80	softner salt
22645	GOPHER STATE ONE-CALL	07-Mar-24	\$6.75	6 tickets
22646	HAWKINS,INC	07-Mar-24	\$168.75	aqua hawk - water plant supplies
22647	RIVER BEND BUSINESS PRODUCTS	07-Mar-24	\$335.04	office supplies, whiteboard calendar for water plant
22648	VOID	07-Mar-24	\$0.00	VOID
22649	LUEPKE OIL & TRUCKING LLC	07-Mar-24	\$250.65	gas, fuel
22650	MINNESOTA DEPARTMENT OF HEALTH	07-Mar-24	\$546.00	1st qtr 2024 service connection fee
22651	MN LIFE INS COMPANY	07-Mar-24	\$10.00	dave life ins feb-mar
22652	Nuvera	07-Mar-24	\$548.70	office,fax,fire hall,lifts,wells,wtr twr,wtr plnt intnet
22653	PROKORE INSPECTIONS, LLC	07-Mar-24	\$106.57	permit fee remittance
22654	RUNNINGS SUPPLY, INC.	07-Mar-24	\$41.87	coupler, torch
22655	COLUMN SOFTWARE PBC	07-Mar-24	\$45.42	notice ph g&s offices 1001 main st
22656	UNITED NATURAL GAS	07-Mar-24	\$1,031.36	main shed, firehall,wtr plant,cityoffice natural gas
			\$53,075.90	

Eric Hauser from Bolton and Menk presents to council the plans and specifications that have been prepared for review with the expectation that council will approve and authorize to advertise for bids. In addition to Collin Drive Improvement Project being bid, Bolton and Menk has prepared the plans and specifications necessary for sidewalk project along County Road 24 for Main Street Park that city has been waiting for approval by Nicollet County. The bids will be separate from each other and council could opt to not proceed with sidewalk of cost is too much. Hauser has received information from Seth Greenwood that a turn lane will be required northbound. Council discussion on what has prompted this and asks for clarification from Seth on specific county policy requirements. Additional discussion on proposed costs for water line stubs to properties and if those that absolutely do not wish to have this put in place will be required to sign documents to that effect and the documents would have time frame they would not be allowed to make connections for possibly 10years. Hauser will draft letters of opting in or out of connection for next month council to consider. Council is in agreement that bidding should move forward to determine costs to be able to move forward.

Rodewald made a motion to approve Resolution 24-109 APPROVING PLANS AND SPECIFICATIONS AND ORDERING ADVERTISEMENT FOR BIDS COLLIN DRIVE IMPROVEMENTS. Kraus seconded the motion. Motion carried with all in favor.

**CITY OF COURTLAND
RESOLUTION 24-109**

**RESOLUTION APPROVING PLANS AND SPECIFICATIONS AND ORDERING ADVERTISEMENT FOR BIDS FOR
THE 2024 COLLIN DRIVE IMPROVEMENT PROJECT.**

WHEREAS, Bolton and Menk, Inc., the consulting engineers for the City, has prepared final plans and specifications for 2024 Collin Drive Improvement Project and such plans and specifications have been presented to the Council for approval.

NOW THEREFORE BE IT RESOLVED BY THE CITY COUNCIL OF THE CITY OF COURTLAND, NICOLLET COUNTY, MINNESOTA.

1. Such plans and specifications are hereby approved and ordered placed on file in the office of the City Clerk.
2. The City Clerk shall prepare and cause to be inserted in the New Ulm Journal, the official newspaper, and online on QuestCDN which qualifies as a regional trade publication, an advertisement for bids upon the making of such improvements under such approved plans and specifications.

The advertisement shall be published in each of said publications at least once not less than three (3) weeks before the date set for opening bids, shall specify the work to be done, shall state that bids will be received until April 2, 2024 at 2:00 p.m. at Courtland City Hall, 329 Main Street, Courtland, Minnesota, at such time they will be publicly opened. No bids will be considered unless submitted as instructed and filed with the City Clerk and accompanied by a cash deposit, cashier's check, bid bond, or certified check payable to the City of Courtland for five percent (5%) of the amount of such bid.

The adoption of the foregoing resolution was duly moved by Councilmember Rodewald and seconded by Councilmember Kraus and after full discussion thereof and upon a vote being taken thereon, the following Councilmembers voted in favor thereof: Bents; Rodewald; Kraus; Bode

and the following voted against the same:

Whereupon said resolution was declared duly passed and adopted. Dated this 7th day of March, 2024.

Richard Krohn has made an application to Nicollet County to combine his lots 240 Ashlynn Court and 290 Collin Drive. Discussion on what the property will be assessed for the improvement project and combining the lots will lessen the amount of assessment. **Rodewald made motion to approve combining 240 Ashlynn Court PID: 14.591.0060 and 290 Collin Drive PID: 14.682.0010. Kraus seconded the motion. Motion carried with all in favor.**

Public Utilities: Dave reported last month main lift station is in need of replacement and the lift stations at Stony Point and Lagoon Drive are in need of repairs. Estimated cost of replacement for main lift station is \$80,000. Dave has made request from Quality Flow for quotes on each lift station. Quality Flow has done the service checks and repairs in the past and he would like to have them continue. Discussion on need for additional bids.

Dave also reports about the lead inventory of service lines will need to be completed in the next few months. This is a requirement by State of MN Health Department. Form letters are available to send out to residents to facilitate gathering the information.

No Mayor Report

Council Report: Bode asks if new chairs for community center have been ordered, Dave reports they have. Disposition of chairs being replaced is discussed.

Planning Commission: Holm reports public hearing for G & S Conditional Use Permit for offices at 1001 Main Street will take place at the March meeting. Continued discussion on doing survey for land use planning.

City Clerk: Julie reports PNP election went well with 100 citizens turning out the day of to vote. Julie will attend MCFOA Clerk's Conference March 19-22 and the city office will be closed.

Unfinished Business: Main Street (Lions) Park; Rodewald has been working to procure bids on equipment and will present at next month meeting.

Clerk presents municipality insurance tort limit liability waiver. Each year on municipality insurance renewal, council must vote on tort limit liability waiver.

Rodewald made a motion to waive tort limit liability. Bode seconded the motion. Motion carried with all in favor.

Dave Ubel as Fire Chief has an updated Mutual Aid Agreement for signature but needs clarification on who will sign. Dave also has copy of Joint Powers Agreement that was voted on at Annual Fire Meeting in February at which no one from city was able to attend. Rodewald asks for clarification of equation calculations.

Bode made a motion to adjourn. Kraus seconded the motion. Motion carried with all in favor.

Meeting adjourned 8:39pm

A signed written copy of the minutes is on file in the office of the city clerk.

Respectfully submitted,

Signed: _____
Ralph Bents, Acting Mayor

Attest: _____
Julie Holm, City Clerk

ABSTRACT OF BIDS

2024 STREET & STORM SEWER IMPROVEMENTS

CITY OF COURTLAND, MN

BMI PROJECT NO.: 0M1.132644

BID DATE: 4/2/2024
TIME: 2:00 PM

ITEM NO.	MNDOT SPEC NO.	ITEM	NOTES	APPROX. QUANT.	UNIT	Engineer's Estimate Bolton & Menk, Inc.		¹ W.W. Blacktopping, Inc. Mankato, MN		² M.R. Paving & Excavating, Inc. New Ulm, MN		³ Precision Underground, LLC Courtland, MN	
						UNIT PRICE	AMOUNT	UNIT PRICE	AMOUNT	UNIT PRICE	AMOUNT	UNIT PRICE	AMOUNT
BASE BID SCHEDULE 1: 2024 COLLIN DRIVE IMPROVEMENTS													
1	2021.501	MOBILIZATION		1	LUMP SUM	\$40,000.00	\$40,000.00	\$17,000.00	\$17,000.00	\$19,430.08	\$19,430.08	\$9,850.00	\$9,850.00
2	2101.502	CLEARING		5	EACH	\$500.00	\$2,500.00	\$420.00	\$2,100.00	\$103.08	\$515.40	\$1,840.00	\$9,200.00
3	2101.502	GRUBBING		5	EACH	\$250.00	\$1,250.00	\$155.00	\$775.00	\$173.35	\$866.75	\$575.00	\$2,875.00
4	2104.502	REMOVE CASTING		1	EACH	\$150.00	\$150.00	\$140.00	\$140.00	\$50.11	\$50.11	\$170.00	\$170.00
5	2104.502	REMOVE DRAINAGE STRUCTURE		1	EACH	\$500.00	\$500.00	\$500.00	\$500.00	\$154.53	\$154.53	\$225.00	\$225.00
6	2104.502	SALVAGE SIGN		1	EACH	\$75.00	\$75.00	\$70.00	\$70.00	\$54.25	\$54.25	\$57.50	\$57.50
7	2104.503	SAWING BITUMINOUS PAVEMENT (FULL DEPTH)		59	LIN FT	\$5.00	\$295.00	\$4.95	\$292.05	\$2.65	\$156.35	\$2.70	\$159.30
8	2104.503	REMOVE SEWER PIPE (STORM)		190	LIN FT	\$10.00	\$1,900.00	\$12.00	\$2,280.00	\$10.63	\$2,019.70	\$2.30	\$437.00
9	2104.503	REMOVE CURB AND GUTTER		15	LIN FT	\$6.00	\$90.00	\$8.00	\$120.00	\$14.17	\$212.55	\$4.00	\$60.00
10	2104.504	REMOVE BITUMINOUS PAVEMENT		84	SQ YD	\$8.00	\$672.00	\$11.50	\$966.00	\$3.26	\$273.84	\$4.59	\$385.56
11	2104.507	REMOVE RIPRAP		20	CU YD	\$30.00	\$600.00	\$30.00	\$600.00	\$17.38	\$347.60	\$4.00	\$80.00
12	2106.507	EXCAVATION - COMMON	(P)(EV)	4805	CU YD	\$15.00	\$72,075.00	\$8.15	\$39,160.75	\$10.58	\$50,836.90	\$5.29	\$25,418.45
13	2106.507	EXCAVATION - SUBGRADE	(EV)(1)(12)	334	CU YD	\$13.00	\$4,342.00	\$8.85	\$2,955.90	\$11.04	\$3,687.36	\$8.28	\$2,765.52
14	2106.507	COMMON EMBANKMENT (CV)	(P)(CV)	105	CU YD	\$10.00	\$1,050.00	\$8.50	\$892.50	\$4.50	\$472.50	\$26.42	\$2,774.10
15	2106.507	STABILIZING AGGREGATE (CV)	(CV)(1)(12)	334	CU YD	\$30.00	\$10,020.00	\$25.00	\$8,350.00	\$37.74	\$12,605.16	\$26.42	\$8,824.28
16	2118.509	AGGREGATE SURFACING CLASS 2	(3)	141	TON	\$40.00	\$5,640.00	\$28.00	\$3,948.00	\$26.88	\$3,790.08	\$38.58	\$5,439.78
17	2123.510	COMMON LABORERS	(1)(2)	10	HOUR	\$90.00	\$900.00	\$55.00	\$550.00	\$47.82	\$478.20	\$85.00	\$850.00
18	2123.510	3.0 CU YD SHOVEL	(1)(2)	5	HOUR	\$170.00	\$850.00	\$135.00	\$675.00	\$189.73	\$948.65	\$145.00	\$725.00
19	2123.510	DOZER	(1)(2)	5	HOUR	\$150.00	\$750.00	\$135.00	\$675.00	\$172.23	\$861.15	\$120.00	\$600.00
20	2123.510	10 CU YD TRUCK	(1)(2)	5	HOUR	\$120.00	\$600.00	\$95.00	\$475.00	\$99.05	\$495.25	\$130.00	\$650.00
21	2123.510	3.0 CU YD FRONT END LOADER	(1)(2)	5	HOUR	\$150.00	\$750.00	\$135.00	\$675.00	\$136.00	\$680.00	\$115.00	\$575.00
22	2123.610	SKID LOADER	(1)(2)	10	HOUR	\$120.00	\$1,200.00	\$125.00	\$1,250.00	\$99.68	\$996.80	\$95.00	\$950.00
23	2211.507	AGGREGATE BASE (CV) CLASS 5	(P)(CV)	990	CU YD	\$30.00	\$29,700.00	\$30.70	\$30,393.00	\$22.31	\$22,086.90	\$50.75	\$50,242.50
24	2211.607	INSTALL AGGREGATE BASE (CV)	(P)(CV)	990	CU YD	\$10.00	\$9,900.00	\$9.60	\$9,504.00	\$8.59	\$8,504.10	\$2.88	\$2,851.20
25	2360.509	TYPE SP 9.5 WEARING COURSE MIXTURE (3;C)	(7)	440	TON	\$80.00	\$35,200.00	\$75.25	\$33,110.00	\$88.73	\$39,041.20	\$86.54	\$38,077.60
26	2360.509	TYPE SP 12.5 NON-WEARING COURSE MIXTURE (3;B)	(7)	1180	TON	\$70.00	\$82,600.00	\$68.50	\$80,830.00	\$73.54	\$86,777.20	\$78.78	\$92,960.40
27	2502.603	DRAIN TILE	(1)(6)	50	LIN FT	\$35.00	\$1,750.00	\$15.00	\$750.00	\$21.52	\$1,076.00	\$3.31	\$165.50
28	2503.503	12" STORM SEWER	(5)	46	LIN FT	\$55.00	\$2,530.00	\$68.00	\$3,128.00	\$55.58	\$2,556.68	\$63.25	\$2,909.50
29	2503.503	15" STORM SEWER	(5)	324	LIN FT	\$60.00	\$19,440.00	\$69.00	\$22,356.00	\$69.18	\$22,414.32	\$69.00	\$22,356.00
30	2503.602	CONNECT TO EXISTING STORM SEWER		2	EACH	\$1,000.00	\$2,000.00	\$665.00	\$1,330.00	\$703.75	\$1,407.50	\$1,500.00	\$3,000.00
31	2503.602	CONNECT INTO EXISTING DRAINAGE STRUCTURE		1	EACH	\$1,200.00	\$1,200.00	\$665.00	\$665.00	\$807.66	\$807.66	\$1,500.00	\$1,500.00
32	2503.602	8"X4" SADDLE	(1)(8)	8	EACH	\$750.00	\$6,000.00	\$2,810.00	\$22,480.00	\$1,648.77	\$13,190.16	\$590.81	\$4,726.48
33	2503.603	4" SANITARY SEWER SERVICE (TRENCHLESS)	(1)(8)	580	LIN FT	\$65.00	\$37,700.00	\$43.00	\$24,940.00	\$51.20	\$29,696.00	\$63.02	\$36,551.60
34	2504.602	ADJUST VALVE BOX		1	EACH	\$500.00	\$500.00	\$200.00	\$200.00	\$218.17	\$218.17	\$250.00	\$250.00
35	2504.602	1" CORPORATION STOP	(1)(8)	10	EACH	\$500.00	\$5,000.00	\$1,250.00	\$12,500.00	\$591.05	\$5,910.50	\$499.10	\$4,991.00
36	2504.602	1" CURB STOP & BOX	(1)(8)	10	EACH	\$500.00	\$5,000.00	\$440.00	\$4,400.00	\$660.69	\$6,606.90	\$676.23	\$6,762.30
37	2504.603	1" WATER SERVICE (TRENCHLESS)	(1)(8)	615	LIN FT	\$50.00	\$30,750.00	\$23.00	\$14,145.00	\$29.39	\$18,074.85	\$19.77	\$12,158.55

ABSTRACT OF BIDS

2024 STREET & STORM SEWER IMPROVEMENTS

CITY OF COURTLAND, MN

BMI PROJECT NO.: 0M1.132644

BID DATE: 4/2/2024
TIME: 2:00 PM

ITEM NO.	MNDOT SPEC NO.	ITEM	NOTES	APPROX. QUANT.	UNIT	Engineer's Estimate Bolton & Menk, Inc.		¹ W.W. Blacktopping, Inc. Mankato, MN		² M.R. Paving & Excavating, Inc. New Ulm, MN		³ Precision Underground, LLC Courtland, MN	
						UNIT PRICE	AMOUNT	UNIT PRICE	AMOUNT	UNIT PRICE	AMOUNT	UNIT PRICE	AMOUNT
38	2504.604	4" POLYSTYRENE INSULATION	(1)	10	SQ YD	\$50.00	\$500.00	\$60.00	\$600.00	\$58.12	\$581.20	\$86.54	\$865.40
39	2506.502	CASTING ASSEMBLY		9	EACH	\$900.00	\$8,100.00	\$815.00	\$7,335.00	\$739.91	\$6,659.19	\$534.75	\$4,812.75
40	2506.502	ADJUST FRAME AND RING CASTING		4	EACH	\$550.00	\$2,200.00	\$360.00	\$1,440.00	\$361.54	\$1,446.16	\$170.00	\$680.00
41	2506.503	CONSTRUCT DRAINAGE STRUCTURE DESIGN 48-4022		11.7	LIN FT	\$575.00	\$6,727.50	\$605.00	\$7,078.50	\$642.14	\$7,513.04	\$589.74	\$6,899.96
42	2506.602	CASTING ASSEMBLY SPECIAL		4	EACH	\$250.00	\$1,000.00	\$180.00	\$720.00	\$242.78	\$971.12	\$1,069.50	\$4,278.00
43	2506.603	CONSTRUCT DRAINAGE STRUCTURE DESIGN SPECIAL 1 (2'X3')		20.8	LIN FT	\$575.00	\$11,960.00	\$465.00	\$9,672.00	\$567.80	\$11,810.24	\$548.46	\$11,407.97
44	2531.503	CONCRETE CURB AND GUTTER DESIGN B618		2440	LIN FT	\$20.00	\$48,800.00	\$20.20	\$49,288.00	\$19.94	\$48,653.60	\$27.97	\$68,246.80
45	2563.601	TRAFFIC CONTROL		1	LUMP SUM	\$10,000.00	\$10,000.00	\$2,000.00	\$2,000.00	\$1,558.85	\$1,558.85	\$1,725.00	\$1,725.00
46	2564.602	INSTALL SIGN		1	EACH	\$400.00	\$400.00	\$300.00	\$300.00	\$108.48	\$108.48	\$1,150.00	\$1,150.00
47	2573.501	STABILIZED CONSTRUCTION EXIT		1	LUMP SUM	\$1,000.00	\$1,000.00	\$665.00	\$665.00	\$1,948.66	\$1,948.66	\$1,150.00	\$1,150.00
48	2573.501	EROSION CONTROL SUPERVISOR		1	LUMP SUM	\$1,500.00	\$1,500.00	\$500.00	\$500.00	\$1,054.86	\$1,054.86	\$2,875.00	\$2,875.00
49	2573.502	STORM DRAIN INLET PROTECTION		8	EACH	\$200.00	\$1,600.00	\$110.00	\$880.00	\$121.01	\$968.08	\$39.39	\$315.12
50	2573.503	SEDIMENT CONTROL LOG TYPE COMPOST		710	LIN FT	\$3.00	\$2,130.00	\$2.95	\$2,094.50	\$2.75	\$1,952.50	\$3.95	\$2,804.50
51	2574.507	COMMON TOPSOIL BORROW (LV)	(LV)(1)	510	CU YD	\$30.00	\$15,300.00	\$22.00	\$11,220.00	\$21.70	\$11,067.00	\$14.35	\$7,318.50
52	2574.508	FERTILIZER TYPE 3	(9)	250	POUND	\$1.50	\$375.00	\$1.00	\$250.00	\$1.30	\$325.00	\$1.38	\$345.00
53	2575.504	ROLLED EROSION PREVENTION CATEGORY 20		4085	SQ YD	\$3.50	\$14,297.50	\$1.70	\$6,944.50	\$1.40	\$5,719.00	\$3.35	\$13,684.75
54	2575.505	SEEDING		0.9	ACRE	\$500.00	\$450.00	\$2,250.00	\$2,025.00	\$519.62	\$467.66	\$10,350.00	\$9,315.00
55	2575.508	SEED MIXTURE 25-131	(10)	255	POUND	\$6.00	\$1,530.00	\$3.25	\$828.75	\$5.20	\$1,326.00	\$5.19	\$1,323.45
56	2575.523	RAPID STABILIZATION METHOD 3	(4)	5.1	MGAL	\$750.00	\$3,825.00	\$450.00	\$2,295.00	\$779.43	\$3,975.09	\$920.00	\$4,692.00
BASE AMOUNT BID:							\$547,174.00		\$451,317.45		\$466,407.08		\$496,463.32
ADD ALTERNATE NO. 1 SCHEDULE 2: 4TH STREET (CSAH 24) SIDEWALK													
57	2021.501	MOBILIZATION		1	LUMP SUM	\$5,000.00	\$5,000.00	\$3,550.00	\$3,550.00	\$1,411.90	\$1,411.90	\$2,500.00	\$2,500.00
58	2104.501	REMOVE CURB AND GUTTER		30	LIN FT	\$6.00	\$180.00	\$4.00	\$120.00	\$13.97	\$419.10	\$11.50	\$345.00
59	2104.502	SALVAGE SIGN		4	EACH	\$75.00	\$300.00	\$70.00	\$280.00	\$54.25	\$217.00	\$57.50	\$230.00
60	2104.502	REMOVE CASTING		1	EACH	\$150.00	\$150.00	\$125.00	\$125.00	\$50.11	\$50.11	\$362.25	\$362.25
61	2104.502	REMOVE DRAINAGE STRUCTURE		1	EACH	\$500.00	\$500.00	\$500.00	\$500.00	\$154.53	\$154.53	\$678.50	\$678.50
62	2104.502	REMOVE SIGN PANEL		1	EACH	\$100.00	\$100.00	\$70.00	\$70.00	\$81.37	\$81.37	\$862.50	\$862.50
63	2104.504	REMOVE CONCRETE DRIVEWAY PAVEMENT		5.5	SQ YD	\$10.00	\$55.00	\$24.00	\$132.00	\$15.23	\$83.77	\$77.36	\$425.48
64	2106.507	COMMON EXCAVATION (P)	(P)(EV)	82	CU YD	\$20.00	\$1,640.00	\$21.00	\$1,722.00	\$18.61	\$1,526.02	\$4.60	\$377.20
65	2106.507	COMMON EMBANKMENT (P)	(P)(CV)	71	CU YD	\$10.00	\$710.00	\$10.50	\$745.50	\$12.67	\$899.57	\$22.97	\$1,630.87
66	2503.503	12" RC PIPE SEWER 3006 CLASS V		35	LIN FT	\$75.00	\$2,625.00	\$110.00	\$3,850.00	\$58.57	\$2,049.95	\$63.25	\$2,213.75
67	2503.602	CONNECT TO EXISTING STORM SEWER		1	EACH	\$1,000.00	\$1,000.00	\$500.00	\$500.00	\$446.18	\$446.18	\$391.00	\$391.00
68	2506.502	CASTING ASSEMBLY		2	EACH	\$1,000.00	\$2,000.00	\$760.00	\$1,520.00	\$713.05	\$1,426.10	\$974.63	\$1,949.26
69	2506.503	CONST DRAINAGE STRUCTURE DESIGN H		2.5	LIN FT	\$500.00	\$1,250.00	\$730.00	\$1,825.00	\$684.59	\$1,711.48	\$1,288.00	\$3,220.00
70	2521.501	6" CONCRETE WALK		1828	SQ FT	\$13.00	\$23,764.00	\$9.20	\$16,817.60	\$9.33	\$17,055.24	\$9.86	\$18,024.08
71	2531.501	CONCRETE CURB & GUTTER DESIGN B618		30	LIN FT	\$40.00	\$1,200.00	\$36.50	\$1,095.00	\$40.66	\$1,219.80	\$39.79	\$1,193.70
72	2531.618	TRUNCATED DOMES		11	SQ FT	\$60.00	\$660.00	\$38.00	\$418.00	\$39.28	\$432.08	\$96.60	\$1,062.60

ABSTRACT OF BIDS

2024 STREET & STORM SEWER IMPROVEMENTS

CITY OF COURTLAND, MN

BMI PROJECT NO.: 0M1.132644

BID DATE: 4/2/2024
TIME: 2:00 PM

ITEM NO.	MNDOT SPEC NO.	ITEM	NOTES	APPROX. QUANT.	UNIT	Engineer's Estimate Bolton & Menk, Inc.		1 W.W. Blacktopping, Inc. Mankato, MN		2 M.R. Paving & Excavating, Inc. New Ulm, MN		3 Precision Underground, LLC Courtland, MN	
						UNIT PRICE	AMOUNT	UNIT PRICE	AMOUNT	UNIT PRICE	AMOUNT	UNIT PRICE	AMOUNT
73	2563.601	TRAFFIC CONTROL		1	LUMP SUM	\$5,000.00	\$5,000.00	\$2,000.00	\$2,000.00	\$1,558.85	\$1,558.85	\$1,725.00	\$1,725.00
74	2564.502	INSTALL SIGN PANEL		1	EACH	\$200.00	\$200.00	\$220.00	\$220.00	\$108.48	\$108.48	\$552.00	\$552.00
75	2564.602	INSTALL SIGN		3	EACH	\$400.00	\$1,200.00	\$225.00	\$675.00	\$108.48	\$325.44	\$644.00	\$1,932.00
76	2573.503	SEDIMENT CONTROL LOG TYPE WOOD FIBER		275	LIN FT	\$3.00	\$825.00	\$3.25	\$893.75	\$2.75	\$756.25	\$3.97	\$1,091.75
77	2573.530	STORM DRAIN INLET PROTECTION		2	EACH	\$200.00	\$400.00	\$100.00	\$200.00	\$121.01	\$242.02	\$109.25	\$218.50
78	2574.507	COMMON TOPSOIL BORROW	(1)	50	CU YD	\$30.00	\$1,500.00	\$22.20	\$1,110.00	\$34.37	\$1,718.50	\$20.99	\$1,049.50
79	2574.508	FERTILIZER TYPE 3	(9)	15	POUND	\$1.50	\$22.50	\$1.00	\$15.00	\$1.30	\$19.50	\$3.83	\$57.45
80	2575.504	ROLLED EROSION PREVENTION CATEGORY 20		245	SQ YD	\$3.50	\$857.50	\$1.70	\$416.50	\$1.56	\$382.20	\$3.52	\$862.40
81	2575.501	SEEDING		0.05	ACRE	\$3,500.00	\$175.00	\$2,250.00	\$112.50	\$2,078.47	\$103.92	\$10,350.00	\$517.50
82	2575.508	SEED MIXTURE 25-151	(13)	15	POUND	\$6.00	\$90.00	\$3.00	\$45.00	\$6.23	\$93.45	\$11.50	\$172.50
ADD ALTERNATE NO. 1 AMOUNT BID:							\$51,404.00		\$38,957.85		\$34,492.80		\$43,644.79
ADD ALTERNATE NO. 2: 4TH STREET (CSAH 24) TURN LANE													
83	2102.503	PAVEMENT MARKING REMOVAL		146	LIN FT	\$1.75	\$255.50	\$2.75	\$401.50	\$10.39	\$1,516.94	\$11.50	\$1,679.00
84	2104.503	SAWING BITUMINOUS PAVEMENT (FULL DEPTH)		384	LIN FT	\$5.00	\$1,920.00	\$3.10	\$1,190.40	\$1.24	\$476.16	\$2.70	\$1,036.80
85	2104.504	REMOVE BITUMINOUS PAVEMENT		139	SQ YD	\$8.00	\$1,112.00	\$8.70	\$1,209.30	\$7.11	\$988.29	\$4.59	\$638.01
86	2106.507	EXCAVATION - COMMON	(P)(EV)	400	CU YD	\$15.00	\$6,000.00	\$12.80	\$5,120.00	\$11.93	\$4,772.00	\$4.60	\$1,840.00
87	2106.507	EXCAVATION - SUBGRADE	(EV)(1)(12)	20	CU YD	\$13.00	\$260.00	\$14.00	\$280.00	\$12.36	\$247.20	\$7.20	\$144.00
88	2106.507	COMMON EMBANKMENT (CV)	(P)(CV)	155	CU YD	\$10.00	\$1,550.00	\$11.00	\$1,705.00	\$4.50	\$697.50	\$22.97	\$3,560.35
89	2106.507	STABILIZING AGGREGATE (CV)	(CV)(1)(12)	20	CU YD	\$30.00	\$600.00	\$25.00	\$500.00	\$43.59	\$871.80	\$22.97	\$459.40
90	2118.509	AGGREGATE SURFACING CLASS 2	(3)	30	TON	\$40.00	\$1,200.00	\$33.50	\$1,005.00	\$31.20	\$936.00	\$33.55	\$1,006.50
91	2211.507	AGGREGATE BASE (CV) CLASS 5	(P)(CV)	240	CU YD	\$30.00	\$7,200.00	\$32.00	\$7,680.00	\$21.68	\$5,203.20	\$44.13	\$10,591.20
92	2360.509	TYPE SP 9.5 WEARING COURSE MIXTURE (3,C)	(7)	50	TON	\$90.00	\$4,500.00	\$90.00	\$4,500.00	\$90.28	\$4,514.00	\$103.50	\$5,175.00
93	2360.509	TYPE SP 12.5 NON-WEARING COURSE MIXTURE (3,B)	(7)	210	TON	\$80.00	\$16,800.00	\$75.00	\$15,750.00	\$82.74	\$17,375.40	\$86.25	\$18,112.50
94	2564.518	SIGN TYPE C		6.25	SQ FT	\$90.00	\$562.50	\$75.00	\$468.75	\$103.92	\$649.50	\$115.00	\$718.75
95	2573.503	SEDIMENT CONTROL LOG TYPE COMPOST		80	LIN FT	\$3.00	\$240.00	\$2.85	\$228.00	\$2.75	\$220.00	\$3.83	\$306.40
96	2574.507	COMMON TOPSOIL BORROW (LV)	(LV)(1)	50	CU YD	\$30.00	\$1,500.00	\$22.20	\$1,110.00	\$34.37	\$1,718.50	\$18.25	\$912.50
97	2574.508	FERTILIZER TYPE 3	(9)	50	POUND	\$1.50	\$75.00	\$1.00	\$50.00	\$1.30	\$65.00	\$3.83	\$191.50
98	2575.504	ROLLED EROSION PREVENTION CATEGORY 20		740	SQ YD	\$3.50	\$2,590.00	\$1.70	\$1,258.00	\$1.56	\$1,154.40	\$3.52	\$2,604.80
99	2575.505	SEEDING		0.2	ACRE	\$500.00	\$100.00	\$2,250.00	\$450.00	\$2,078.47	\$415.69	\$10,350.00	\$2,070.00
100	2575.508	SEED MIXTURE 25-141	(11)	15	POUND	\$6.00	\$90.00	\$4.00	\$60.00	\$6.23	\$93.45	\$11.50	\$172.50
101	2575.523	RAPID STABILIZATION METHOD 3	(4)	1	MGAL	\$750.00	\$750.00	\$475.00	\$475.00	\$779.42	\$779.42	\$920.00	\$920.00
102	2582.503	6" SOLID LINE PAINT		326	LIN FT	\$0.50	\$163.00	\$1.20	\$391.20	\$0.91	\$296.66	\$2.88	\$938.88
103	2582.518	PAVEMENT MESSAGE PAINT		15.45	SQ FT	\$5.00	\$77.25	\$6.00	\$92.70	\$18.83	\$290.92	\$11.50	\$177.68
ADD ALTERNATE NO. 2 AMOUNT BID:							\$47,545.25		\$43,924.85		\$43,282.04		\$53,255.77
TOTAL AMOUNT BID (BASE + ADD ALTERNATE NO. 1 AND 2):							\$646,123.25		\$534,200.15		\$544,181.92		\$593,363.87

ABSTRACT OF BIDS

2024 STREET & STORM SEWER IMPROVEMENTS

CITY OF COURTLAND, MN

BMI PROJECT NO.: 0M1.132644

BID DATE: 4/2/2024
TIME: 2:00 PM

ITEM NO.	MNDOT SPEC NO.	ITEM	NOTES	APPROX. QUANT.	UNIT	Engineer's Estimate Bolton & Menk, Inc.		1 W.W. Blacktopping, Inc. Mankato, MN		2 M.R. Paving & Excavating, Inc. New Ulm, MN		3 Precision Underground, LLC Courtland, MN	
						UNIT PRICE	AMOUNT	UNIT PRICE	AMOUNT	UNIT PRICE	AMOUNT	UNIT PRICE	AMOUNT

NOTES:

- (P) DENOTES PLANNED QUANTITY
- (CV) DENOTES COMPACTED VOLUME QUANTITY
- (LV) DENOTES LOOSE VOLUME QUANTITY
- (EV) DENOTES EXCAVATED VOLUME QUANTITY

- (1) QUANTITY IS STRICTLY AN ESTIMATE AND MAY BE INCREASED OR DECREASED BY ANY AMOUNT WITHOUT A CHANGE IN THE UNIT PRICE BID.
- (2) ITEM TO BE USED FOR EXPLORATORY EXCAVATION AND OTHER MISCELLANEOUS WORK AS DIRECTED BY THE ENGINEER.
- (3) AGGREGATE SURFACING = 1.89 TON PER CU YD.
- (4) ITEM TO BE USED FOR TEMPORARY STABILIZATION. RAPID STABILIZATION METHOD 3 TO BE APPLIED AT A RATE OF 6000 GAL/ACRE.
- (5) THE CONTRACTOR MAY ELECT TO UTILIZE CONCRETE PIPE (RCP) OR PLASTIC PIPE (PVC).
- (6) ITEM TO BE USED FOR REPAIRING UNKNOWN DRAIN TILES ENCOUNTERED DURING CONSTRUCTION.
- (7) BITUMINOUS MIXTURE SPWEA340C & SPNWB330B = 113 LB PER SQ YD-INCH
- (8) QUANTITY ASSUMES ALL SERVICES SHOWN WILL BE INSTALLED. THE ENGINEER WILL BE RESPONSIBLE FOR DETERMINING WHICH SERVICES ARE REQUIRED TO BE INSTALLED.
- (9) FERTILIZER TYPE 3 = 300 POUNDS/ACRE (N-P-K RATIO = 22-5-10).
- (10) SEED MIXTURE 25-131 = 330 POUNDS/ACRE
- (11) SEED MIXTURE 25-141 = 88.5 POUNDS/ACRE
- (12) ITEM TO BE USED AS DIRECTED BY THE ENGINEER DURING ROADWAY CONSTRUCTION FOR CORRECTIVE EXCAVATION BEYOND THE PLANNED TYPICAL SECTION.
- (13) SEED MIXTURE 25-151 = 180 POUNDS/ACRE

ABSTRACT OF BIDS

2024 STREET & STORM SEWER IMPROVEMENTS

CITY OF COURTLAND, MN

BMI PROJECT NO.: 0M1.132644

BID DATE: 4/2/2024
TIME: 2:00 PM

ITEM NO.	MNDOT SPEC NO.	ITEM	NOTES	APPROX. QUANT.	UNIT	4		5	
						Mensing Construction LLC		GM Contracting, Inc.	
						Blue Earth, MN		Lake Crystal, MN	
						UNIT PRICE	AMOUNT	UNIT PRICE	AMOUNT
BASE BID SCHEDULE 1: 2024 COLLIN DRIVE IMPROVEMENTS									
1	2021.501	MOBILIZATION		1	LUMP SUM	\$20,533.65	\$20,533.65	\$127,759.57	\$127,759.57
2	2101.502	CLEARING		5	EACH	\$729.80	\$3,649.00	\$455.00	\$2,275.00
3	2101.502	GRUBBING		5	EACH	\$394.20	\$1,971.00	\$150.00	\$750.00
4	2104.502	REMOVE CASTING		1	EACH	\$324.45	\$324.45	\$473.93	\$473.93
5	2104.502	REMOVE DRAINAGE STRUCTURE		1	EACH	\$309.00	\$309.00	\$473.93	\$473.93
6	2104.502	SALVAGE SIGN		1	EACH	\$165.00	\$165.00	\$100.00	\$100.00
7	2104.503	SAWING BITUMINOUS PAVEMENT (FULL DEPTH)		59	LIN FT	\$2.70	\$159.30	\$1.65	\$97.35
8	2104.503	REMOVE SEWER PIPE (STORM)		190	LIN FT	\$5.28	\$1,003.88	\$9.98	\$1,896.20
9	2104.503	REMOVE CURB AND GUTTER		15	LIN FT	\$8.50	\$127.50	\$5.42	\$81.30
10	2104.504	REMOVE BITUMINOUS PAVEMENT		84	SQ YD	\$3.80	\$319.20	\$3.25	\$273.00
11	2104.507	REMOVE RIPRAP		20	CU YD	\$14.16	\$283.20	\$16.27	\$325.40
12	2106.507	EXCAVATION - COMMON	(P)(EV)	4805	CU YD	\$7.46	\$35,845.30	\$6.08	\$29,214.40
13	2106.507	EXCAVATION - SUBGRADE	(EV)(1)(12)	334	CU YD	\$6.14	\$2,050.76	\$0.01	\$3.34
14	2106.507	COMMON EMBANKMENT (CV)	(P)(CV)	105	CU YD	\$11.17	\$1,172.85	\$6.08	\$638.40
15	2106.507	STABILIZING AGGREGATE (CV)	(CV)(1)(12)	334	CU YD	\$51.27	\$17,124.18	\$0.01	\$3.34
16	2118.509	AGGREGATE SURFACING CLASS 2	(3)	141	TON	\$33.55	\$4,730.55	\$26.98	\$3,804.18
17	2123.510	COMMON LABORERS	(1)(2)	10	HOUR	\$65.00	\$650.00	\$80.00	\$800.00
18	2123.510	3.0 CU YD SHOVEL	(1)(2)	5	HOUR	\$179.00	\$895.00	\$150.00	\$750.00
19	2123.510	DOZER	(1)(2)	5	HOUR	\$130.00	\$650.00	\$150.00	\$750.00
20	2123.510	10 CU YD TRUCK	(1)(2)	5	HOUR	\$85.00	\$425.00	\$125.00	\$625.00
21	2123.510	3.0 CU YD FRONT END LOADER	(1)(2)	5	HOUR	\$130.00	\$650.00	\$125.00	\$625.00
22	2123.610	SKID LOADER	(1)(2)	10	HOUR	\$100.00	\$1,000.00	\$120.00	\$1,200.00
23	2211.507	AGGREGATE BASE (CV) CLASS 5	(P)(CV)	990	CU YD	\$28.54	\$28,254.60	\$18.40	\$18,216.00
24	2211.607	INSTALL AGGREGATE BASE (CV)	(P)(CV)	990	CU YD	\$9.09	\$8,999.10	\$9.12	\$9,028.80
25	2360.509	TYPE SP 9.5 WEARING COURSE MIXTURE (3;C)	(7)	440	TON	\$89.22	\$39,256.80	\$79.97	\$35,186.80
26	2360.509	TYPE SP 12.5 NON-WEARING COURSE MIXTURE (3;B)	(7)	1180	TON	\$79.08	\$93,314.40	\$74.00	\$87,320.00
27	2502.603	DRAIN TILE	(1)(6)	50	LIN FT	\$16.40	\$820.00	\$30.34	\$1,517.00
28	2503.503	12" STORM SEWER	(5)	46	LIN FT	\$48.07	\$2,211.22	\$77.76	\$3,576.96
29	2503.503	15" STORM SEWER	(5)	324	LIN FT	\$54.61	\$17,693.64	\$87.91	\$28,482.84
30	2503.602	CONNECT TO EXISTING STORM SEWER		2	EACH	\$521.00	\$1,042.00	\$1,421.73	\$2,843.46
31	2503.602	CONNECT INTO EXISTING DRAINAGE STRUCTURE		1	EACH	\$547.00	\$547.00	\$1,895.66	\$1,895.66
32	2503.602	8"X4" SADDLE	(1)(8)	8	EACH	\$1,085.75	\$8,686.00	\$1,224.26	\$9,794.08
33	2503.603	4" SANITARY SEWER SERVICE (TRENCHLESS)	(1)(8)	580	LIN FT	\$104.35	\$60,523.00	\$50.00	\$29,000.00
34	2504.602	ADJUST VALVE BOX		1	EACH	\$240.00	\$240.00	\$325.30	\$325.30
35	2504.602	1" CORPORATION STOP	(1)(8)	10	EACH	\$898.80	\$8,988.00	\$400.00	\$4,000.00
36	2504.602	1" CURB STOP & BOX	(1)(8)	10	EACH	\$992.75	\$9,927.50	\$500.00	\$5,000.00
37	2504.603	1" WATER SERVICE (TRENCHLESS)	(1)(8)	615	LIN FT	\$54.70	\$33,640.50	\$25.00	\$15,375.00

ABSTRACT OF BIDS

2024 STREET & STORM SEWER IMPROVEMENTS

CITY OF COURTLAND, MN

BMI PROJECT NO.: 0M1.132644

BID DATE: 4/2/2024
TIME: 2:00 PM

ITEM NO.	MNDOT SPEC NO.	ITEM	NOTES	APPROX. QUANT.	UNIT	4		5	
						Mensing Construction LLC		GM Contracting, Inc.	
						Blue Earth, MN		Lake Crystal, MN	
						UNIT PRICE	AMOUNT	UNIT PRICE	AMOUNT
38	2504.604	4" POLYSTYRENE INSULATION	(1)	10	SQ YD	\$36.00	\$360.00	\$0.01	\$0.10
39	2506.502	CASTING ASSEMBLY		9	EACH	\$900.75	\$8,106.75	\$325.27	\$2,927.43
40	2506.502	ADJUST FRAME AND RING CASTING		4	EACH	\$377.50	\$1,510.00	\$325.27	\$1,301.08
41	2506.503	CONSTRUCT DRAINAGE STRUCTURE DESIGN 48-4022		11.7	LIN FT	\$574.75	\$6,724.58	\$793.18	\$9,280.21
42	2506.602	CASTING ASSEMBLY SPECIAL		4	EACH	\$202.75	\$811.00	\$325.27	\$1,301.08
43	2506.603	CONSTRUCT DRAINAGE STRUCTURE DESIGN SPECIAL 1 (2'X3')		20.8	LIN FT	\$453.80	\$9,439.04	\$713.62	\$14,843.30
44	2531.503	CONCRETE CURB AND GUTTER DESIGN B618		2440	LIN FT	\$22.00	\$53,680.00	\$21.19	\$51,703.60
45	2563.601	TRAFFIC CONTROL		1	LUMP SUM	\$2,046.00	\$2,046.00	\$2,500.00	\$2,500.00
46	2564.602	INSTALL SIGN		1	EACH	\$1,100.00	\$1,100.00	\$300.00	\$300.00
47	2573.501	STABILIZED CONSTRUCTION EXIT		1	LUMP SUM	\$1,683.00	\$1,683.00	\$2,147.60	\$2,147.60
48	2573.501	EROSION CONTROL SUPERVISOR		1	LUMP SUM	\$955.00	\$955.00	\$2,500.00	\$2,500.00
49	2573.502	STORM DRAIN INLET PROTECTION		8	EACH	\$140.00	\$1,120.00	\$150.00	\$1,200.00
50	2573.503	SEDIMENT CONTROL LOG TYPE COMPOST		710	LIN FT	\$3.62	\$2,570.20	\$2.95	\$2,094.50
51	2574.507	COMMON TOPSOIL BORROW (LV)	(LV)(1)	510	CU YD	\$37.62	\$19,186.20	\$40.00	\$20,400.00
52	2574.508	FERTILIZER TYPE 3	(9)	250	POUND	\$1.83	\$457.50	\$1.00	\$250.00
53	2575.504	ROLLED EROSION PREVENTION CATEGORY 20		4085	SQ YD	\$2.05	\$8,374.25	\$1.70	\$6,944.50
54	2575.505	SEEDING		0.9	ACRE	\$3,020.00	\$2,718.00	\$2,250.00	\$2,025.00
55	2575.508	SEED MIXTURE 25-131	(10)	255	POUND	\$5.27	\$1,343.85	\$3.25	\$828.75
56	2575.523	RAPID STABILIZATION METHOD 3	(4)	5.1	MGAL	\$595.50	\$3,037.05	\$450.00	\$2,295.00
BASE AMOUNT BID:							\$533,405.00		\$549,323.38
ADD ALTERNATE NO. 1 SCHEDULE 2: 4TH STREET (CSAH 24) SIDEWALK									
57	2021.501	MOBILIZATION		1	LUMP SUM	\$1,856.80	\$1,856.80	\$4,000.00	\$4,000.00
58	2104.501	REMOVE CURB AND GUTTER		30	LIN FT	\$8.50	\$255.00	\$10.84	\$325.20
59	2104.502	SALVAGE SIGN		4	EACH	\$165.00	\$660.00	\$100.00	\$400.00
60	2104.502	REMOVE CASTING		1	EACH	\$324.45	\$324.45	\$65.05	\$65.05
61	2104.502	REMOVE DRAINAGE STRUCTURE		1	EACH	\$340.00	\$340.00	\$237.83	\$237.83
62	2104.502	REMOVE SIGN PANEL		1	EACH	\$200.00	\$200.00	\$100.00	\$100.00
63	2104.504	REMOVE CONCRETE DRIVEWAY PAVEMENT		5.5	SQ YD	\$9.50	\$52.25	\$14.78	\$81.29
64	2106.507	COMMON EXCAVATION (P)	(P)(EV)	82	CU YD	\$7.65	\$627.30	\$11.83	\$970.06
65	2106.507	COMMON EMBANKMENT (P)	(P)(CV)	71	CU YD	\$12.50	\$887.50	\$11.48	\$815.08
66	2503.503	12" RC PIPE SEWER 3006 CLASS V		35	LIN FT	\$48.50	\$1,697.50	\$68.38	\$2,393.30
67	2503.602	CONNECT TO EXISTING STORM SEWER		1	EACH	\$510.00	\$510.00	\$947.81	\$947.81
68	2506.502	CASTING ASSEMBLY		2	EACH	\$900.75	\$1,801.50	\$325.27	\$650.54
69	2506.503	CONST DRAINAGE STRUCTURE DESIGN H		2.5	LIN FT	\$508.00	\$1,270.00	\$954.52	\$2,386.30
70	2521.501	6" CONCRETE WALK		1828	SQ FT	\$9.50	\$17,366.00	\$12.08	\$22,082.24
71	2531.501	CONCRETE CURB & GUTTER DESIGN B618		30	LIN FT	\$38.20	\$1,146.00	\$44.00	\$1,320.00
72	2531.618	TRUNCATED DOMES		11	SQ FT	\$43.50	\$478.50	\$65.00	\$715.00

ABSTRACT OF BIDS

2024 STREET & STORM SEWER IMPROVEMENTS

CITY OF COURTLAND, MN

BMI PROJECT NO.: 0M1.132644

BID DATE: 4/2/2024
TIME: 2:00 PM

ITEM NO.	MNDOT SPEC NO.	ITEM	NOTES	APPROX. QUANT.	UNIT	4		5	
						Mensing Construction LLC		GM Contracting, Inc.	
						Blue Earth, MN		Lake Crystal, MN	
						UNIT PRICE	AMOUNT	UNIT PRICE	AMOUNT
73	2563.601	TRAFFIC CONTROL		1	LUMP SUM	\$1,650.00	\$1,650.00	\$1,000.00	\$1,000.00
74	2564.502	INSTALL SIGN PANEL		1	EACH	\$165.00	\$165.00	\$100.00	\$100.00
75	2564.602	INSTALL SIGN		3	EACH	\$1,100.00	\$3,300.00	\$300.00	\$900.00
76	2573.503	SEDIMENT CONTROLL LOG TYPE WOOD FIBER		275	LIN FT	\$3.50	\$962.50	\$3.25	\$893.75
77	2573.530	STORM DRAIN INLET PROTECTION		2	EACH	\$140.00	\$280.00	\$150.00	\$300.00
78	2574.507	COMMON TOPSOIL BORROW	(1)	50	CU YD	\$36.75	\$1,837.50	\$45.00	\$2,250.00
79	2574.508	FERTILIZER TYPE 3	(9)	15	POUND	\$5.70	\$85.50	\$1.00	\$15.00
80	2575.504	ROLLED EROSION PREVENTION CATEGORY 20		245	SQ YD	\$2.30	\$563.50	\$1.70	\$416.50
81	2575.501	SEEDING		0.05	ACRE	\$3,994.00	\$199.70	\$2,250.00	\$112.50
82	2575.508	SEED MIXTURE 25-151	(13)	15	POUND	\$7.70	\$115.50	\$2.75	\$41.25
ADD ALTERNATE NO. 1 AMOUNT BID:							\$38,632.00		\$43,518.70
ADD ALTERNATE NO. 2: 4TH STREET (CSAH 24) TURN LANE									
83	2102.503	PAVEMENT MARKING REMOVAL		146	LIN FT	\$7.94	\$1,159.24	\$2.00	\$292.00
84	2104.503	SAWING BITUMINOUS PAVEMENT (FULL DEPTH)		384	LIN FT	\$2.70	\$1,036.80	\$4.17	\$1,601.28
85	2104.504	REMOVE BITUMINOUS PAVEMENT		139	SQ YD	\$3.80	\$528.20	\$3.77	\$524.03
86	2106.507	EXCAVATION - COMMON	(P)(EV)	400	CU YD	\$7.45	\$2,980.00	\$21.65	\$8,660.00
87	2106.507	EXCAVATION - SUBGRADE	(EV)(1)(12)	20	CU YD	\$6.15	\$123.00	\$0.10	\$2.00
88	2106.507	COMMON EMBANKMENT (CV)	(P)(CV)	155	CU YD	\$12.20	\$1,891.00	\$39.43	\$6,111.65
89	2106.507	STABILIZING AGGREGATE (CV)	(CV)(1)(12)	20	CU YD	\$51.27	\$1,025.40	\$0.01	\$0.20
90	2118.509	AGGREGATE SURFACING CLASS 2	(3)	30	TON	\$33.55	\$1,006.50	\$47.96	\$1,438.80
91	2211.507	AGGREGATE BASE (CV) CLASS 5	(P)(CV)	240	CU YD	\$28.54	\$6,849.60	\$55.33	\$13,279.20
92	2360.509	TYPE SP 9.5 WEARING COURSE MIXTURE (3;C)	(7)	50	TON	\$120.75	\$6,037.50	\$91.26	\$4,563.00
93	2360.509	TYPE SP 12.5 NON-WEARING COURSE MIXTURE (3;B)	(7)	210	TON	\$90.35	\$18,973.50	\$85.50	\$17,955.00
94	2564.518	SIGN TYPE C		6.25	SQ FT	\$110.00	\$687.50	\$72.00	\$450.00
95	2573.503	SEDIMENT CONTROL LOG TYPE COMPOST		80	LIN FT	\$4.15	\$332.00	\$2.85	\$228.00
96	2574.507	COMMON TOPSOIL BORROW (LV)	(LV)(1)	50	CU YD	\$37.00	\$1,850.00	\$50.00	\$2,500.00
97	2574.508	FERTILIZER TYPE 3	(9)	50	POUND	\$2.50	\$125.00	\$1.00	\$50.00
98	2575.504	ROLLED EROSION PREVENTION CATEGORY 20		740	SQ YD	\$2.05	\$1,517.00	\$1.70	\$1,258.00
99	2575.505	SEEDING		0.2	ACRE	\$2,926.75	\$585.35	\$2,250.00	\$450.00
100	2575.508	SEED MIXTURE 25-141	(11)	15	POUND	\$9.15	\$137.25	\$4.00	\$60.00
101	2575.523	RAPID STABILIZATION METHOD 3	(4)	1	MGAL	\$615.31	\$615.31	\$475.00	\$475.00
102	2582.503	6" SOLID LINE PAINT		326	LIN FT	\$4.85	\$1,581.10	\$5.00	\$1,630.00
103	2582.518	PAVEMENT MESSAGE PAINT		15.45	SQ FT	\$55.00	\$849.75	\$20.00	\$309.00
ADD ALTERNATE NO. 2 AMOUNT BID:							\$49,891.00		\$61,837.16
TOTAL AMOUNT BID (BASE + ADD ALTERNATE NO. 1 AND 2):							\$621,928.00		\$654,679.24

ABSTRACT OF BIDS

2024 STREET & STORM SEWER IMPROVEMENTS

CITY OF COURTLAND, MN

BMI PROJECT NO.: 0M1.132644

BID DATE: 4/2/2024
TIME: 2:00 PM

ITEM NO.	MNDOT SPEC NO.	ITEM	NOTES	APPROX. QUANT.	UNIT	4 Mensing Construction LLC Blue Earth, MN		5 GM Contracting, Inc. Lake Crystal, MN	
						UNIT PRICE	AMOUNT	UNIT PRICE	AMOUNT

NOTES:

- (P) DENOTES PLANNED QUANTITY
- (CV) DENOTES COMPACTED VOLUME QUANTITY
- (LV) DENOTES LOOSE VOLUME QUANTITY
- (EV) DENOTES EXCAVATED VOLUME QUANTITY

- (1) QUANTITY IS STRICTLY AN ESTIMATE AND MAY BE INCREASED OR DECREASED BY ANY AMOUNT WITHOUT A CHANGE IN THE UNIT PRICE BID.
- (2) ITEM TO BE USED FOR EXPLORATORY EXCAVATION AND OTHER MISCELLANEOUS WORK AS DIRECTED BY THE ENGINEER.
- (3) AGGREGATE SURFACING = 1.89 TON PER CU YD.
- (4) ITEM TO BE USED FOR TEMPORARY STABILIZATION. RAPID STABILIZATION METHOD 3 TO BE APPLIED AT A RATE OF 6000 GAL/ACRE.
- (5) THE CONTRACTOR MAY ELECT TO UTILIZE CONCRETE PIPE (RCP) OR PLASTIC PIPE (PVC).
- (6) ITEM TO BE USED FOR REPAIRING UNKNOWN DRAIN TILES ENCOUNTERED DURING CONSTRUCTION.
- (7) BITUMINOUS MIXTURE SPWEA340C & SPNWB330B = 113 LB PER SQ YD-INCH
- (8) QUANTITY ASSUMES ALL SERVICES SHOWN WILL BE INSTALLED. THE ENGINEER WILL BE RESPONSIBLE FOR DETERMINING WHICH SERVICES ARE REQUIRED TO BE INSTALLED.
- (9) FERTILIZER TYPE 3 = 300 POUNDS/ACRE (N-P-K RATIO = 22-5-10).
- (10) SEED MIXTURE 25-131 = 330 POUNDS/ACRE
- (11) SEED MIXTURE 25-141 = 88.5 POUNDS/ACRE
- (12) ITEM TO BE USED AS DIRECTED BY THE ENGINEER DURING ROADWAY CONSTRUCTION FOR CORRECTIVE EXCAVATION BEYOND THE PLANNED TYPICAL SECTION.
- (13) SEED MIXTURE 25-151 = 180 POUNDS/ACRE

x/xx/2024

[Insert Property Owner Name]

RE: 2024 Collin Drive Improvement Project
Construction Agreement for Service Connections
Parcel Identification No. [Insert PID]
[Insert Property Address]

Dear Property Owner:

The City of Courtland is in the process of preparing for the improvement of Collin Drive in the summer of 2024. The project is planned to provide sanitary sewer and water service connections (Service Connections) to properties where none exist currently, install storm sewer, curb and gutter, and bituminous pavement along Collin Drive. The City has a duty to minimize future disturbances that have a potential to decrease the longevity of the improvements.

Therefore, in accordance with the planned improvements, we have devised an agreement that outlines two options for the service connections on your property. Please carefully review the following options:

Option 1: City Constructed Service Connections

Under this option, the City will undertake the construction of the Service Connections for your property. The hired contractor will handle all aspects of the construction process, including all necessary labor and materials. The Service Connections will be installed to meet current standards and specifications. The installation costs of the Service Connections will be the responsibility of the Property Owner. These **costs** are estimated to be **\$9,800** and shall be assessed against the property. Payment shall follow current City policy for payment of special assessments. **The City also requires a service hookup fee** in the amount of **\$8,000** and is due within **60 days** of the effective date of the attached agreement.

Option 2: Waiver of Right to Construct Service Connections

Alternatively, you may choose to delay your ability to construct service connections for your property for a minimum period of 10 years. All construction costs associated with future installation of the service connections will be your sole responsibility. The required service hookup fee to be paid shall be according to the City's fee schedule at the time of connection.

We have enclosed a formal agreement outlining the terms and conditions of each option for your review and consideration. Please take the time to carefully assess both options and indicate your choice by checking the appropriate box and signing the agreement accordingly under the observation of a notary.

Please contact Dave Ubel 507-276-8413 or Eric Hauser 507-276-6695 or Eric.Hauser@bolton-menk.com with any questions or to arrange a convenient time to meet with you.

On behalf of the City, we wish to thank you for your cooperation and assistance and we look forward to working with you to complete this project. We would request your consideration of this offer by **May 1, 2024.**

Sincerely,

Dave Ubel
Public Works Superintendent
City of Courtland

Attachments: Construction Agreement

CONSTRUCTION AGREEMENT

THIS AGREEMENT is made by [Insert Property Owner name] first party, hereinafter "Owner", and the City of Courtland, a municipal corporation under the laws of the State of Minnesota, second party, hereinafter "the City".

The parties represent and affirm that:

WHEREAS, first party is the owner of real property situated in the City of Courtland, County of Nicollet, State of Minnesota, described as follows:

Address: [Insert Address]

Parcel Number: [Insert Parcel Identification Number]

hereinafter "the Property"; and

WHEREAS, the City is constructing an improvement project on land abutting the Property; and,

WHEREAS, there are not any existing water and sanitary sewer service connections running from the City mains to the Property line (hereinafter "the Service Connections"); and,

WHEREAS, the City will not permit any non-emergency future disturbance to the proposed improvements for a minimum period of **ten (10) years** following the completion of the improvement project; and

WHEREAS, the City is willing to construct the Service Connections, provided that Owner bear the cost thereof as specified below (it being understood that Owner may elect to hire an independent contractor to construct the Service Connections subject to all applicable laws, ordinances, codes, regulations, and policies);

NOW THEREFORE, the parties agree to the following terms:

Option 1: City Construction of the Service Connections

1. Owner hereby requests that the City construct the Service Connections up to Owner's property line in conjunction with the City's larger public improvement project. Owner understands and acknowledges that the Service Connections are not a part of the public improvement project, and the cost of the Service Connections shall not be considered part of the assessments for the public improvement project if those assessments are appealed by Owner for any reason.

2. Owner grants to the City a construction easement to enter upon the Property for purposes of constructing the Service Connections according to City standards.

3. There are two separate costs for the Service Connections. The first is the construction related cost which is estimated to be \$9,800 which estimate is based on the following expected costs to the City in constructing the Service Connections:

Contract Item	Units	Unit Price	Quantity	Item Total
SEWER SERVICE CONNECTION	EACH	\$5,000	1	\$5,000
WATER SERVICE CONNECTION	EACH	\$4,800	1	\$4,800
TOTAL ESTIMATED CONSTRUCTION COST				\$9,800

Additionally, there is an \$8,000 service hookup fee for the service connections.

4. For the convenience of the Owner the total cost of construction of the Service Connections, in an amount consistent with the estimate set forth in Paragraph 3 above, subject to reasonable variation owing to unexpected circumstances or conditions at the Property, shall be assessed against the Property, separately or together with the assessments for the aforesaid City improvements project, and shall be paid by Owner according to the current City policy concerning payment of such special assessments.

5. The cost of the service hookup fee is due to the City within 60 days of the effective date of this Agreement.

6. Owner acknowledges the benefit to the Property and to Owner of having the City construct the Service Connections described herein and spread the cost thereof over time, and hereby waives any objections or rights of appeal which Owner may otherwise have with respect to the assessment for the Service Connections agreed to in Paragraph 4 above, whether the same be based upon procedural error under Minnesota Statutes Ch. 429 or other law, ordinance or regulation, or upon a claim that the amount of the assessment is excessive, or upon any other alleged defect.

7. Owner hereby holds the City harmless of all future maintenance and replacement costs resulting from the Service Connections.

8. The right of entry granted hereunder shall continue until the Service Connections are completed but in no event later than December 31, 2024, on which date it shall terminate automatically unless extended in writing by the parties. The obligation to pay for the Service Connections and the waiver of objections and appeal rights shall continue until paid in full.

9. The work is warranted and guaranteed for a period of two (2) years from the date of Final Completion of the City's larger public improvement project.

they executed the same as their free act and deed.

Notary Public

CITY:

By:_____

Its:_____

STATE OF MINNESOTA)
) -ss-
COUNTY OF)

On this ____ day of _____, 20____, before me a Notary Public within and for said County, personally appeared _____, to me personally known, who being each by me duly sworn did say that they are respectively the City Administrator of the municipal corporation named in the foregoing instrument, and that the seal affixed to said instrument is the corporate seal of said municipal corporation, and the said instrument was signed and sealed on behalf of said municipal corporation by authority of its City Council and said City Administrator acknowledged said instrument to be the free act and deed of said municipal corporation.

Notary Public

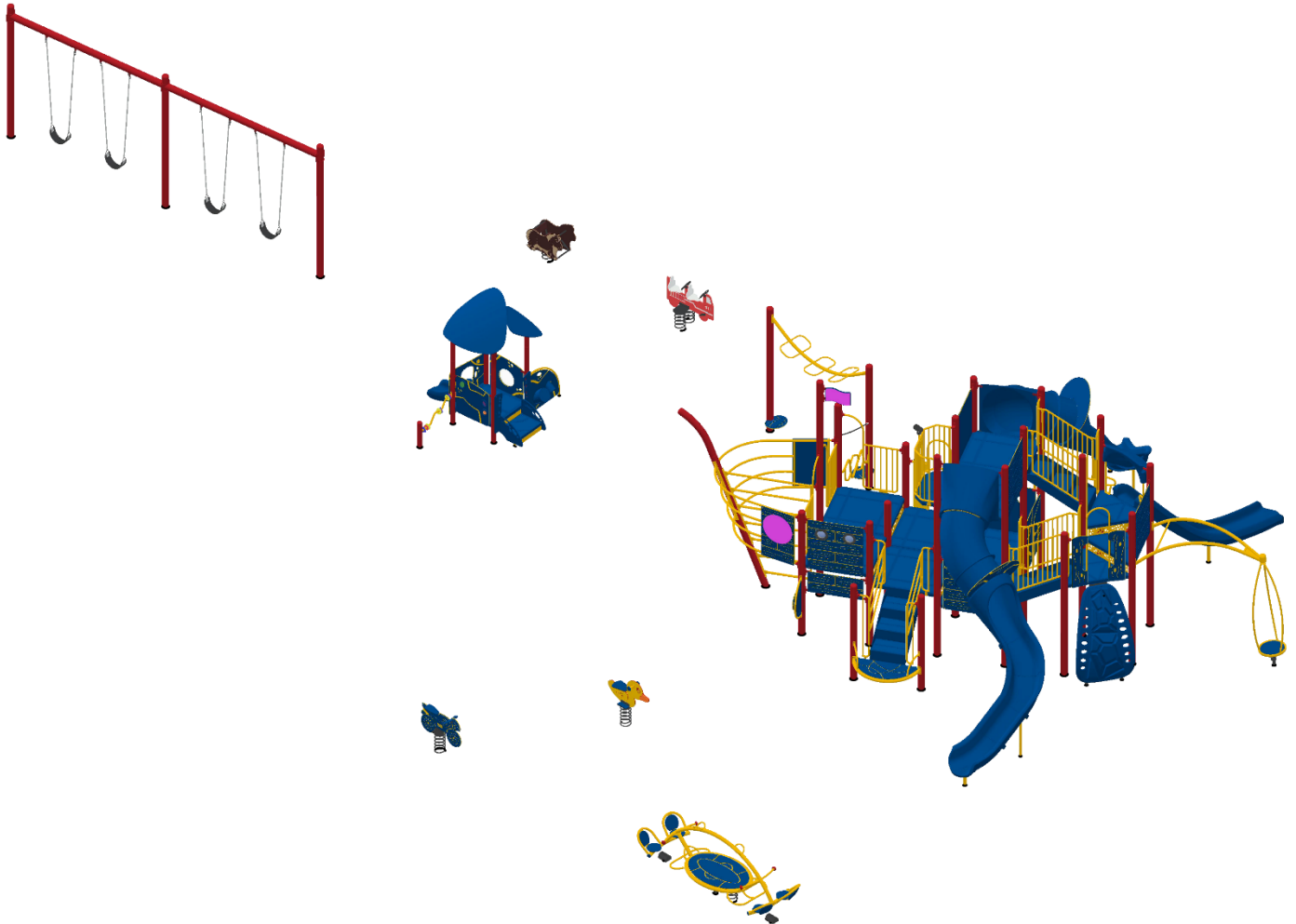

St. Croix Recreation Fun Playgrounds Inc.

1826 Tower Dr W | Stillwater, MN 55082 | 651-430-1247

Proposal 100-182347-1 | 3/26/2024

OUR MISSION IS TO BRING
PLAY THAT MOVES YOU.
TO COMMUNITIES AROUND
THE WORLD

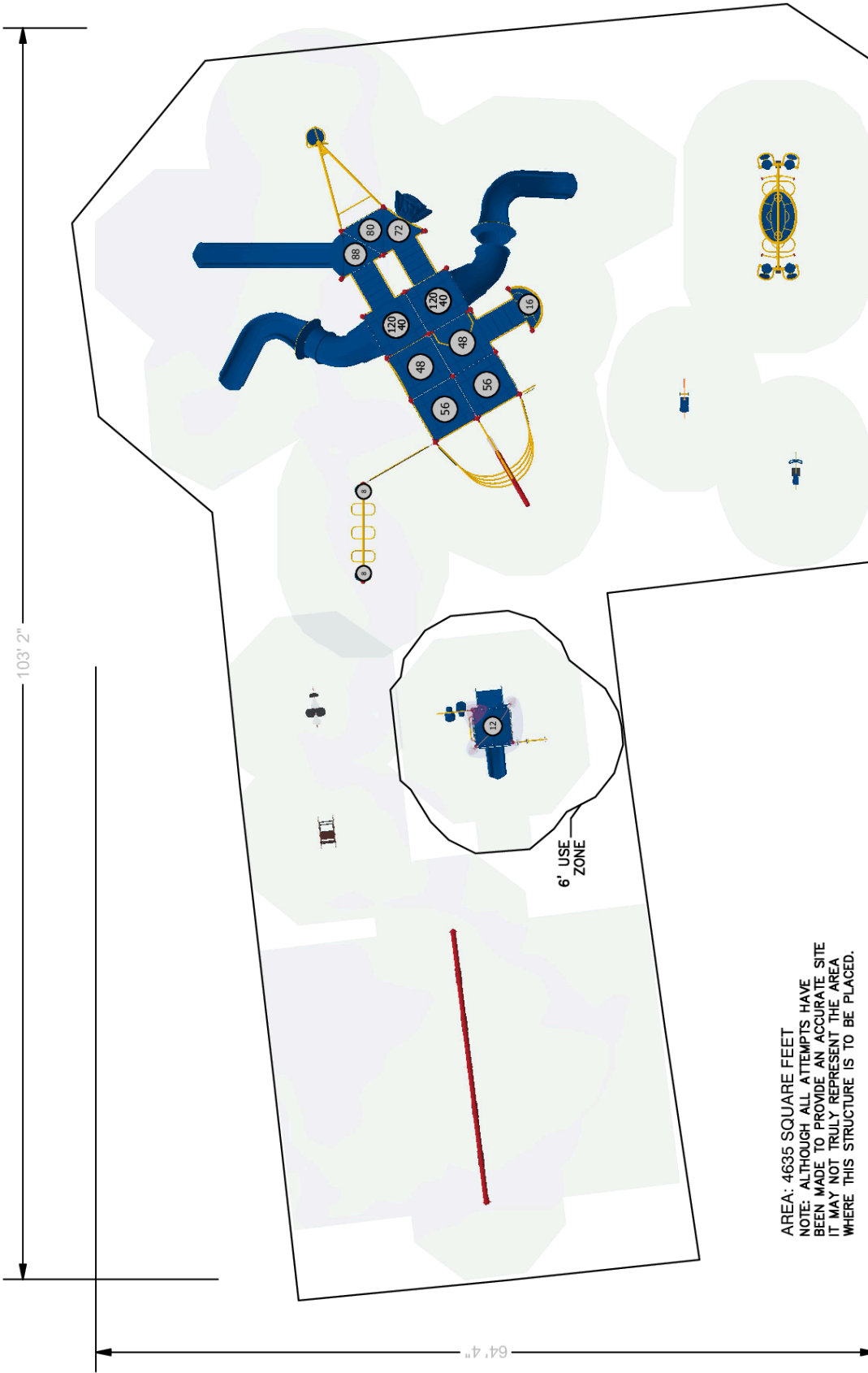

The use and layout of play components identified in this plan conform to the CPSC guidelines. U.S. CPSC recommends the separation of age groups in playground layouts.

PLAYGROUND ACCESSIBILITY (Provided/Required)			
TOTAL ELEVATED EVENTS	TRANSFER ACCESSIBLE EVENTS	RAMP ACCESSIBLE EVENTS	TYPES OF GROUND EVENTS
26	12 / 6	0 / 0	16 / 4
			8 / 3

OVERALL BOUNDING OF USE ZONES ***The space requirements shown here are to ASTM standards. Requirements for other standards may be different.

Area: 6629.7 sq.ft.
 Perimeter: 334.8 ft.
STRUCTURE SIZE: 4"x103' 2"
POST SIZE(S): 3.5"

AREA: 4635 SQUARE FEET
 NOTE: ALTHOUGH ALL ATTEMPTS HAVE BEEN MADE TO PROVIDE AN ACCURATE SITE IT MAY NOT TRULY REPRESENT THE AREA WHERE THIS STRUCTURE IS TO BE PLACED.

Warning: Accessible safety surfacing material is required beneath and around this equipment that is compliant with ASTM, CPSC, and ADAAG requirements.

SERIES Nucleus | Intensity | Synergy | Burke Basics

SITE PLAN VIEW

GROUP:
5-12 Structure|SY-3000|Freestanding

Main Street Park
Courtland, MN 56021

03/26/2024

DESIGNED FOR AGES:
5 to 12, 6 to 23, 2 to 12



St. Croix Recreation Fun Playgrounds
100-182347-1

Designer: Brandy Janke

DESIGN SUMMARY

St. Croix Recreation Fun Playgrounds Inc. is very pleased to present this Proposal for consideration for the Main Street Park located in Courtland. BCI Burke Company, LLC has been providing recreational playground equipment for over 100 years and has developed the right mix of world-class capabilities to meet the initial and continuing needs of Courtland Playground Committee. We believe our proposal will meet or exceed your project's requirements and will deliver the greatest value to you.

The following is a summary of some of the key elements of our Proposal:

- Project Name: Main Street Park
- Project Number: 100-182347-1
- User Capacity: 147
- Age Groups: 5 to 12, 6 to 23, 2 to 12
- Dimensions: 101' 11"x64' 3"
- Designer Name: Brandy Janke

St. Croix Recreation Fun Playgrounds Inc. has developed a custom playground configuration based on the requirements as they have been presented for the Main Street Park playground project. Our custom design will provide a safe and affordable playground environment that is aesthetically pleasing, full of fun for all users and uniquely satisfies your specific requirements. In addition, proposal # 100-182347-1 has been designed with a focus on safety, and is fully compliant with ASTM F1487 and CPSC playground safety standards.

We invite you to review this proposal for the Main Street Park playground project and to contact us with any questions that you may have.

Thank you in advance for giving us the opportunity to make this project a success.

March 26, 2024

Pam Rodewald
Courtland Playground Committee
329 Main Street
Courtland, MN 56021
Phone: 507-354-7055

Dear Pam Rodewald:

St. Croix Recreation Fun Playgrounds Inc. is delighted to provide Courtland Playground Committee with this playground equipment proposal.

This design was developed with your specific needs in mind, and we look forward to discussing this project further with you to ensure your complete satisfaction. St. Croix Recreation Fun Playgrounds Inc. is confident that this proposal will satisfy Courtland Playground Committee's functional, environmental, and safety requirements -- and most importantly -- bring joy and excitement to the children and families directly benefiting from your new playground.

You have our personal commitment to support this project and your organization in every manner possible, and we look forward to developing a long-standing relationship with Courtland Playground Committee. We appreciate your consideration and value this opportunity to earn your business.

Sincerely,

Johnnie Johnsen
Sales Representative

St. Croix Recreation Fun Playgrounds Inc.
1826 Tower Dr W
Stillwater, MN 55082
www.funplaygrounds.com
www.bciburke.com

Phone: 651-430-1247
Fax: -
jj@stcroixrec.com

OUR MISSION IS TO BRING
PLAY THAT MOVES YOU®
TO COMMUNITIES AROUND
THE WORLD

The play components identified in this proposal are IPEMA certified. The use and layout of these components conform to the requirements of ASTM F1487. To verify product certification, visit www.ipema.org.



The space requirements shown in this proposal are to ASTM standards. Requirements for other standards may be different.

Component No.	Description	Qty	User Cap	Ext. User Cap	Weight	Ext. Weight
5-12 Structure						
Nucleus						
072-0500-108C	5" OD X 108" CAPPED POST	2	0	0	57	114
072-0500-116C	5" OD X 116" CAPPED POST	1	0	0	61	61
072-0500-132C	5" OD X 132" CAPPED POST	5	0	0	69	345
072-0500-148C	5" OD X 148" CAPPED POST	1	0	0	78	78
072-0500-156C	5" OD X 156" CAPPED POST	2	0	0	82	164
072-0500-164C	5" OD X 164" CAPPED POST	1	0	0	86	86
072-0500-180C	5" OD X 180" CAPPED POST	2	0	0	94	188
072-0500-196C	5" OD X 196" CAPPED POST	6	0	0	103	618
072-0500-208C	5" OD X 208" CAPPED POST	1	0	0	109	109
270-0001	OFFSET ENCLOSURE	3	0	0	30	90
270-0009	8" CLOSURE PLATE, ELLIPSE	6	0	0	8	48
270-0129	TRIANGLE PLATFORM	3	2	6	48	144
270-0130	SQUARE PLATFORM	8	6	48	106	848
270-0148	BALCONY	1	2	2	99	99
270-0285	NP UNITARY ENCLOSURE	2	0	0	42	84
370-0140	SHIP BOW CLIMBER 56"	1	12	12	366	366
370-0468	32" TRANSITION STAIR W/BARRIERS	2	3	6	215	430
370-0471	32" TRANSITION STAIR W/GUARDR...	1	3	3	183	183
370-0862	TREE BRANCH CLIMBER 48"	1	2	2	17	17
370-1648	MANITOU CLIMBER 72"	1	4	4	86	86
370-1651	TRANGO CLIMBER, POST TO POST	1	5	5	32	32
470-0075	CRESCENT PLATFORM	1	1	1	52	52
470-0758	VELO XL SLIDE, 88"-96" W/O HOOD	1	2	2	134	134
470-0787	COBRA SLIDE FUSION "S" LEFT 120"	1	2	2	324	324
470-0788	COBRA SLIDE FUSION "S" RIGHT ...	1	2	2	324	324
470-0967	SLIDE HOOD, LOW SIDE WALL	1	0	0	37	37
570-0516	TELESCOPE ASSEMBLY	1	1	1	7	7
570-0735	FLAG POST TOPPER, JOLLY ROGER	1	0	0	9	9
570-0742	SHIP BOARD PANEL 17", BELOW P...	2	0	0	22	44
570-1732	SHIP BOARD PANEL 41"	2	0	0	45	90
570-1733	SHIP BOARD PANEL W/ PORT HOLE...	3	2	6	47	141
570-1734	SHIP BOARD PANEL W/ PIRATE 41"	1	0	0	45	45
570-1858	3-IN-A-ROW PANEL, ABOVE PLATFORM	1	2	2	45	45
570-2705	SPINNER CRESCENT PANEL	1	1	1	17	17
600-0104	NPPS SUPERVISION SAFETY KIT	1	0	0	3	3
660-0103	MAINTENANCE KIT, STRUCTURE	1	0	0	7	7
660-0104	INSTALLATION KIT, STRUCTURE	1	0	0	5	5

5-12 Structure

Intensity

370-1581	SPINNER, FIERCE CYCLONE	1	3	3	155	155
370-1608	OVISTEP LAUNCH PAD	2	1	2	10	20
370-1610	ATHLETIC ARCH OH	1	5	5	45	45

Total User Capacity: 115
 Total Weight: 5694 lbs.
 Total Price: \$80,224

Freestanding

Burke Basics

550-0111	BELT SEAT, 8' SINGLE, STD CHAIN	4	1	4	10	40
550-0201	SINGLE POST SWING ASSEMBLY 5" OD	1	0	0	220	220
550-0202	SINGLE POST SWING ADD-ON 5" OD	1	0	0	145	145
570-0767	2-SEAT FIRE TRUCK	1	2	2	109	109
570-0769	MOTORCYCLE ROCK N RIDE	1	1	1	66	66
570-0835	HORSE RIDER	1	1	1	80	80
570-2696	DUCKLING ROCKER	1	1	1	67	67
570-2727	ORB ROCKER FOOTER	1	0	0	93	93
570-2745	ORB ROCKER	1	8	8	540.9	540.9
660-0101	INSTALL KIT, BURKE BASICS - P...	1	0	0	2	2

Total User Capacity: 17
 Total Weight: 1363 lbs.
 Total Price: \$19,705

SY-3000

Synergy

072-0300-51C	3 1/2" OD X 51" CAPPED POST	1	0	0	19	19
072-0302-89S	3 1/2" OD X 89" SWAGED POST	3	0	0	33	99
072-0302-97S	3 1/2" OD X 97" SWAGED POST	1	0	0	36	36
290-0102	SQUARE PLATFORM	1	4	4	59	59
290-0127	18" X 24" PLATFORM, 6-23	1	2	2	60	60
490-0107	ELATION ROOF SINGLE POST	1	0	0	65	65
490-0108	ELATION ROOF 3 POST	1	0	0	92	92
490-0188	SPARK SLIDE	1	1	1	80	80
590-0413	BUBBLE WINDOW PLAY PANEL, 6-23	1	2	2	28	28
590-0414	ABACUS 6-23	1	2	2	9	9
590-0416	DRUM ACTIVITY ARCH	1	2	2	34	34
590-0418	SENSORY PLAY PANEL, 6-23	1	2	2	25	25

Total User Capacity: 15
 Total Weight: 606 lbs.
 Total Price: \$8,684

Special Notes:

Prices do not include freight, unloading, material storage, site excavation/preparation, removal of existing equipment, removal of excess soil from footing holes, site security, safety surfacing, installation, or sales tax (if applicable). Prices are based on standard colors per CURRENT YEAR BCI Burke Catalog. Custom colors, where available, would be an extra charge. **Pricing is valid for 30 days from the date of this proposal.**

COLOR SELECTION LIST | Default Color Option

GROUP 1 (5-12 Structure)

Deck: Blue
Post: Red
Acc: Yellow
Panel: Blue-Yellow-Blue
Flat: Blue
Plastic: Blue

GROUP 2 (SY-3000)

Deck: Blue
Post: Red
Acc: Yellow
Plastic: Blue
Panel: Blue-Yellow-Blue
Flat: Blue

GROUP 3 (Freestanding)

Post: Red
Flat: Blue | Orange | Brown
Panel: Yellow-Red-Yellow | Blue-Yellow-Blue | Brown-Tan-Brown
Acc: Yellow



MIDWEST PLAYSAPES, INC.
8632 Eagle Creek Circle
Savage, MN 55378

EQUIPMENT SIZE:
See DWG

USE ZONE:
See DWG

AREA: **5,869 SqFt.** PERIMETER: **372 Ft.**

FALL HEIGHT:
8 Ft.

USER CAPACITY: AGE GROUP:
2-12

ADA SCHEDULE	Total Elevated Play Activities: 5		
	Total Ground-Level Play Activities: 2		
	Accessible Elevated Activities	Accessible Ground-Level Activities	Accessible Ground-Level Play Types
Required	3	2	2
Provided	5	2	2

- ASTM F1487-17
- CPSC #325



PROJECT NO:
TJ031424-01

SCALE:
NTS

DRAWN BY:
M Lokowich

Paper Size

DATE:
03-14-24

B

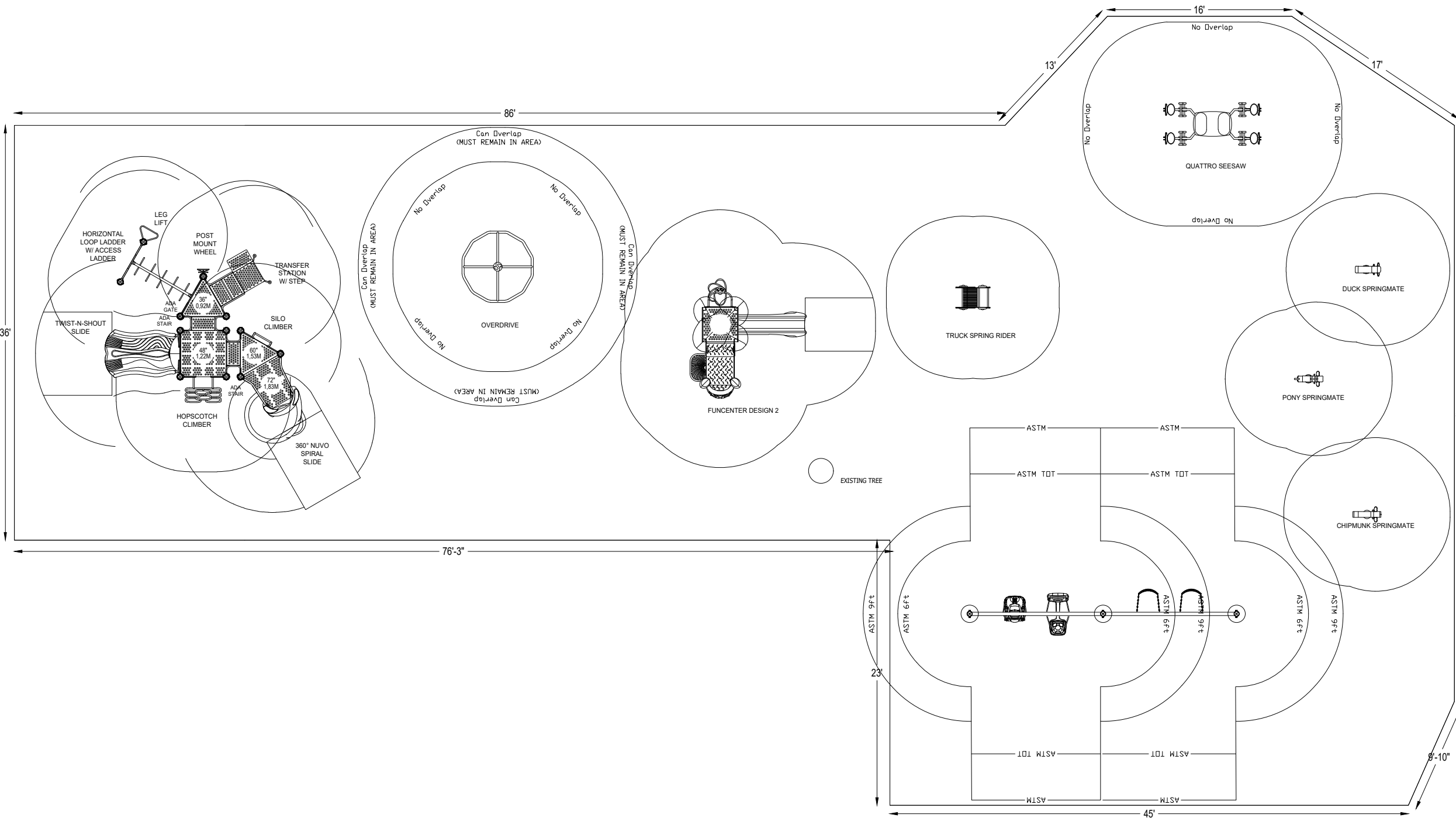

*PLAYGROUND SUPERVISION REQUIRED

Community of Courtland
Courtland, MN



8632 Eagle Creek Circle, Savage, MN 55378
 www.MIDWESTPLAYSCAPES.com

direct: 952.895.8888
 fax:952.895.8889
 toll free: 800.747.1452

playscapes@earthlink.net

Quotation



Project: City of Courtland	Phone: 507-217-7052
Contact: Pam Rodewald	Fax:
Ship To: 210 Railroad St. Courtland MN 56021	Bill To:
Email: pmeyer118@gmail.com	ATTN:
Shipping Contact Name:	Date: 3/14/24

Qty	Design/Item #	Description	Price each	Total
		Playmarker Superhero		\$35,000.00
		Fun Center#2		\$13,844.00
		Quattro Seesaw		\$7,913.00
		Overdrive		\$5,150.00
		Spring Mates-Pony, Turtle, Duck with Anchor Footing		\$5,379.00
		Spring Truck		\$2,682.00
		Single Post 2 Bay Swing-ADA, Swing Along, 2 Belts		\$6,780.00
		Co-op 17% Discount		(\$13,047.00)
300 yards		EWF Mulch-Delievered-Installed		\$12,500.00
			Subtotal	\$ 76,201.00
			Freight	\$ 3,740.00
Tax Exempt # _____ * Please provide certifica			Sales Tax	\$ 5,499.94
			Local Sales Tax	\$ 399.71
No Removal or Excavation			Subtotal	\$ 85,840.65
			Total	\$ 85,840.65

NOTE: Options

<input type="checkbox"/>	Add \$1000 if customer would like Midwest Playscapes to unload freight.	
<input type="checkbox"/>	Add \$800 if customer would like Midwest Playscapes to dispose of packaging material.	
<input type="checkbox"/>	Installation, Labor and Equipment	\$ 14,450.00

NOTE: Freight Quotes are good for 10 days from quote date above, due to rising fuel costs. Quote will need to be re-evaluated after this time frame.

NOTE: Customer would be responsible for unloading and installation.

NOTE: Any Insurance requirements above \$1,000,000 General Liability will be subject to a surcharge

NOTE: UNLESS OTHERWISE NOTED, prices shown are material only. They DO NOT include: assembly, installation, border, safety surfacing, drain tile, geotextile fabric, removal of existing equipment, site preparation, excavation or site restoration, unloading of equipment, disposal of packaging material, storage of equipment, additional insurance and bonding would be extra, unless otherwise stated above. If playground equipment or materials are stored off site, customer is responsible for transporting equipment to job site.

NOTE: Customer must mark site in white paint for utilities to be located prior to Midwest Playscapes arrival.

NOTE: Prices firm for 30 days, subject to review thereafter. Our terms are net 30. A finance charge of 1.5% will be imposed on the outstanding balance unpaid for more than 30 days after the shipment of materials. Equipment shall be invoiced seperately from other services and shall be payable in advance of those services and project completion. Retainage not accepted. Once customer has signed quotation, your order cannot be changed or canceled. Please allow TBD weeks for delivery after receipt of order. Standard manufacturing design, specification, and construction apply unless noted otherwise. Customer is responsible for the identification and marking of all underground utilities (public or private) to include drain tile and sprinkler systems. Area must be accessible to Bobcat and other equipment necessary for installation or additional fees will be charged. Freight quote is based on customer unloading equipment and checking in all equipment for any missing parts. If product is refused by customer upon delivery for any reason (unless damaged), without prior authorization from Midwest Playscapes, Inc., the customer agrees to pay 20% restocking fee plus freight charges. Price does not include prevailing wages, unless otherwise noted. If we can be of Other Assistance, please feel free to contact us.

Signed: _____
 Tom Joachim

Accepted _____
 Date: _____
 Printed Name: _____

Quote summary



Huntsville Playground × 1

PKP286

\$34,627.00



Cantilever Swing Set × 1

4 Belt Swings 1 Bucket Swing / Pacific Blue

PSW210WS PB

\$2,419.00



Four-Seat In Ground Spring Rider × 1

Blue

SPR-00014-B

\$2,400.00



JennSwing ADA Swing Seat × 1

Red

382-411R

\$680.00



Naples Playground × 1

PKP294

\$10,811.00



Bumbling Betsy Fun Bouncer × 1

PFB005

\$654.00



Tommy Truck Fun Bouncer × 1

PFB003

\$488.00



Poly Pony Fun Bouncer × 1
PFB002

\$488.00



Rescue Truck Multi Passenger Spring Rider × 1
IP-7020-WS

\$2,375.00

Standard Installation

\$28,509.00

Playground Equipment Crating Fee × 1

Over 10 Feet

\$240.00

Discount  GOOD THROUGH 3-15-2024 **-\$6,500.00**

Subtotal **\$77,191.00**

Shipping **\$4,997.00**

MN STATE TAX **\$3,709.42**

MN SPECIAL TAX **\$269.79**

Total **\$86,167.21 USD**

You saved \$6,971.00